



# electric

low voltage

Version 1

# MCCB

## Moulded Case Circuit Breakers



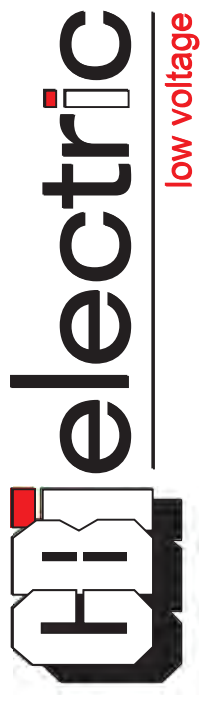

# Silently Protecting Lives & Property



the only manufacturer of Circuit Breakers on the African continent.

Quality, Energy Efficient Electrical Protection Equipment.



Purposefully Differentiated

## Index

General Overview.....	Page 1
G15D / G25D Data Sheet.....	Page 2
G15D / G25D Dimensional Drawings.....	Page 3
F15D / F25D Data Sheet.....	Page 4
F15D / F25D Dimensional Drawings.....	Page 5
G35D Data Sheet.....	Page 6
G35D Dimensional Drawings.....	Page 7
F35D Data Sheet.....	Page 8
F35D Dimensional Drawings.....	Page 9
F65DV Data Sheet.....	Page 10
F65DV Dimensional Drawings.....	Page 11
K25D Data Sheet.....	Page 12
K25D Dimensional Drawings.....	Page 13
K35D Data Sheet.....	Page 14
K35D Dimensional Drawings.....	Page 15
K35DE Data Sheet.....	Page 16
K35DE Dimensional Drawings.....	Page 17
K50D Data Sheet.....	Page 18
K50D Dimensional Drawings.....	Page 19
K50DE Data Sheet.....	Page 20
K50DE Dimensional Drawings.....	Page 21
K70DE Data Sheet.....	Page 22
K70DE Dimensional Drawings.....	Page 23
L50DE Data Sheet.....	Page 24
L50DE Dimensional Drawings.....	Page 25
L70DE Data Sheet.....	Page 26
L70DE Dimensional Drawings.....	Page 27
N85DE 1000 / 1250 Data Sheet.....	Page 28
N85DE 1000 / 1250 Dimensional Drawings.....	Page 29
N85DE 1600 Data Sheet.....	Page 30
N85DE 1600 Dimensional Drawings.....	Page 31
Technical Information.....	Page 32
Cascading Table.....	Page 33



# General Overview



## Triple Pole Circuit Breakers (Mixed Load)

Type	Poles	Terminals	kA@		No. of Interphase Barriers	Rating (A)
			415 V	525 V		
G15D	3	G1	15	15	2	16, 20, 32, 40, 50, 63
		G1	15	15		80, 100
		G1	15	15		125
F15D	3	G1	15	15	4	150, 160
		G1	15	15		175, 200, 225
		G4B	15	15		250
G25D	3	G1	25	18	2	16, 20, 32, 40, 50, 63
		G1	25	18		80, 100
		G1	25	18		125
F25D	3	G1	25	22	4	150, 160
		G1	25	22		175, 200, 225
		G4B	25	22		250
G35D	3	G1	35	22	2	16, 20, 32, 40, 50, 63
		G1	35	22		80, 100
F35D	3	G1	35	22	4	125
		G1	35	30		150, 160
		G1	35	30		175, 200, 225
		G4B	35	30		250
F65DV	3	G1	65	35	4	20-25, 32-40, 45-63
		G1	65	35		70-100
		G1	65	35		90-125
		G1	65	35		125-160
		G4B	65	35		175-250

## KD Circuit Breakers (Mixed Load)

Type	Poles	Terminals	kA@			No. of Interphase Barriers	Rating (A)
			415 V	500 V	525 V		
K25D	3	G4B	25	22	-	4	250
	3	G4B	25	22	-	4	300, 350, 400
K35D	3	G4B	35	30	30	4	250
	3	G4B	35	30	30	4	300, 350, 400
	3	G4B	36	22	-	4	500, 630
K50D	3	G4B	50	40	35	4	500, 630

## KDE Electronic Circuit Breakers (Adjustable)

Type	Poles	Terminals	kA@			No. of Interphase Barriers	Rating (A)
			415 V	500 V	525 V		
K35DE	3	G4B	35	30	30	4	200-400
K50DE	3	G4B	50	40	35	4	300-630
K65DE	3	G4B	65	50	50	4	200-400
K70DE	3	G4B	70	50	-	4	300-630

## Triple Pole Circuit Breakers (Mixed Load) Electronic Adjustable

Type	Poles	Terminals	kA@		No. of Interphase Barriers	Rating (A)
			415 V	500 V		
N85DE	3	G4B	85++	65++	2	500-1000
	3				2	600-1250

# G15D / G25D Data Sheet



Model		G15D	G25D
Rated current I <sub>n</sub> (A)		16, 20, 32, 40, 50, 63, 80, 100, 125	16, 20, 32, 40, 50, 63, 80, 100, 125
Number of poles		3	3
Rated insulation voltage U <sub>i</sub> (V)		690	690
Rated short-circuit breaking capacity (kA)	IEC 60947-2 (Icu/Ics)	AC 690V	8/8
		525V	15/9
		500V	15/9
		415V	15/15
DC 250VDC	15/15	25/25	
Standard attached parts (front connection)		Mounting screw: M4x0.7x55 3P: 2pcs Insulation barrier: 3P: 2pcs	

## Operating Characteristics

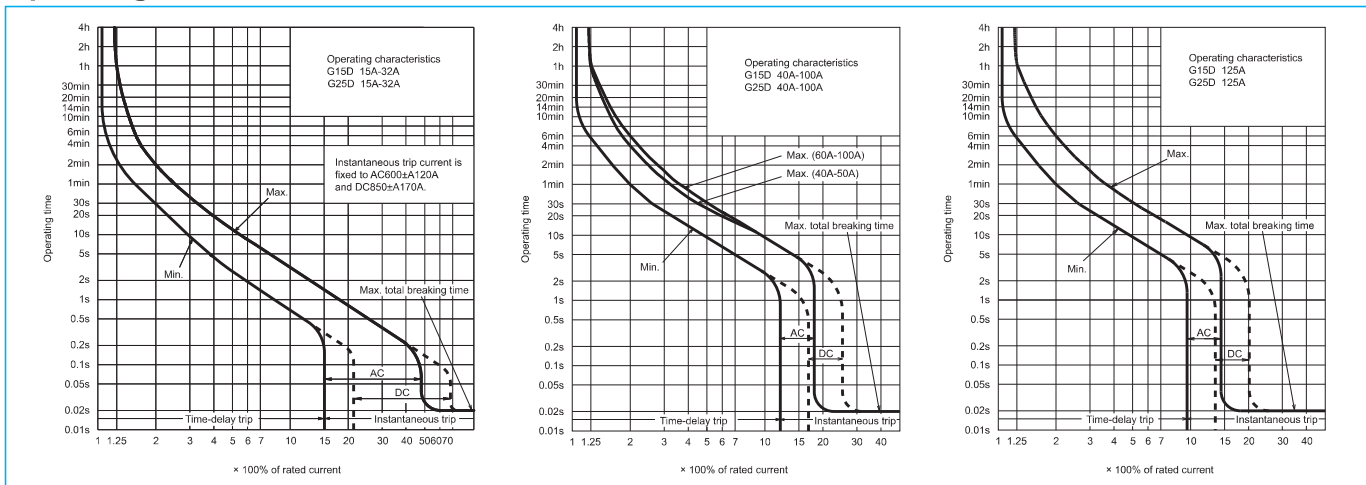

## Internal Accessories

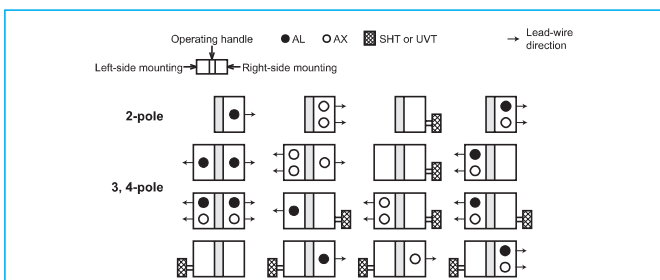

## Temperature Compensation Curve

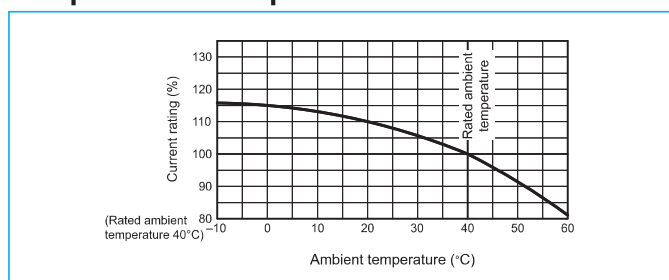

# G15D / G25D Dimensional Drawings

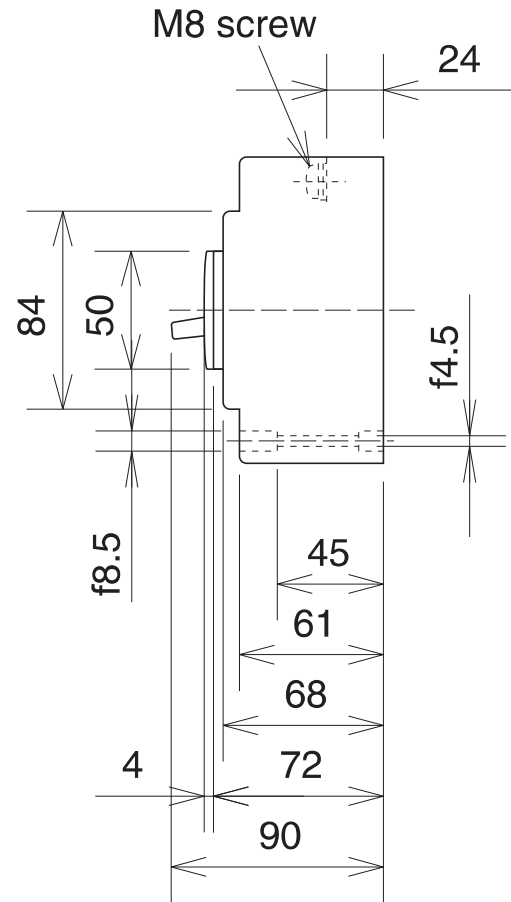
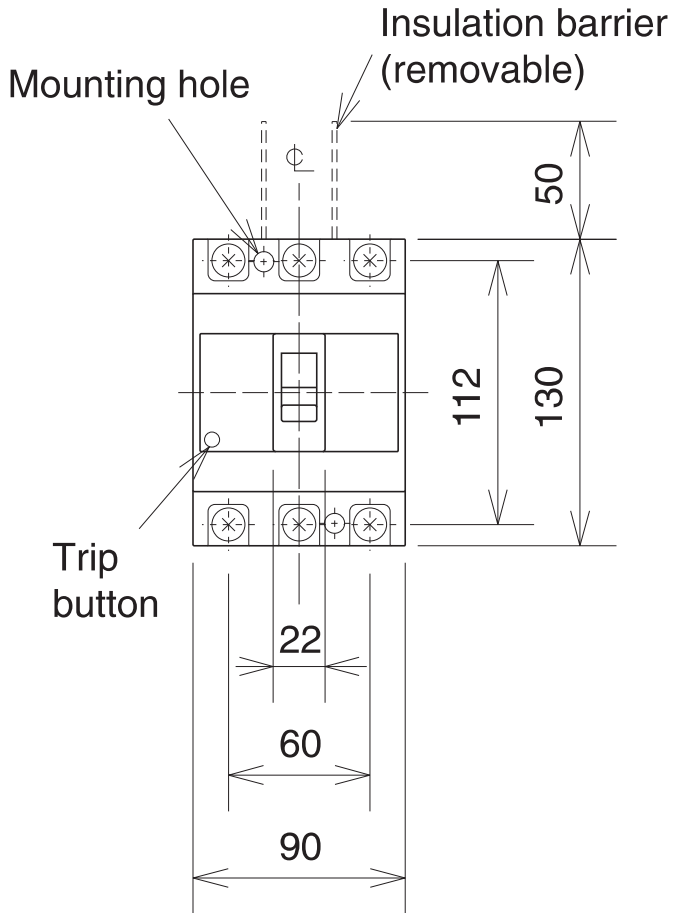

## 3-pole

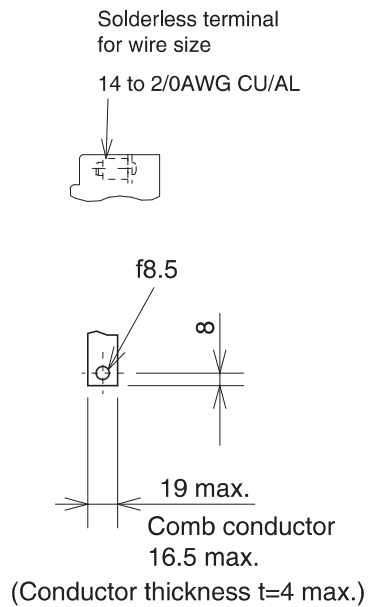

Conductor drilling

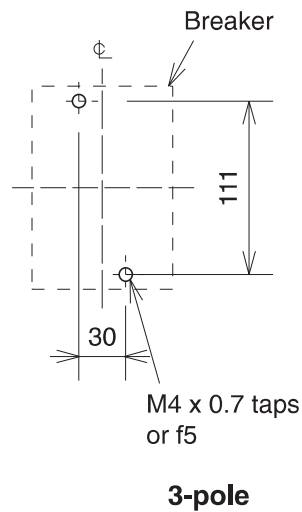

Drilling plan

# F15D / F25D Data Sheet



Model		F15D	F25D
Rated current I <sub>n</sub> (A)		125, 150, 160, 175, 200, 225, 250	125, 150, 160, 175, 200, 225, 250
Number of poles		3	3
Rated insulation voltage U <sub>i</sub> (V)		690	690
Rated short-circuit breaking capacity (kA)	IEC 60947-2 (Icu/Ics)	AC 690V	8/8
		525V	15/15
		500V	15/15
		415V	25/25
DC 250V	20/20		
Standard attached parts (front connection)		Mounting screw: M4×0.7×55 3P: 2pcs Insulation barrier: 3P: 2pcs	

## Operating Characteristics

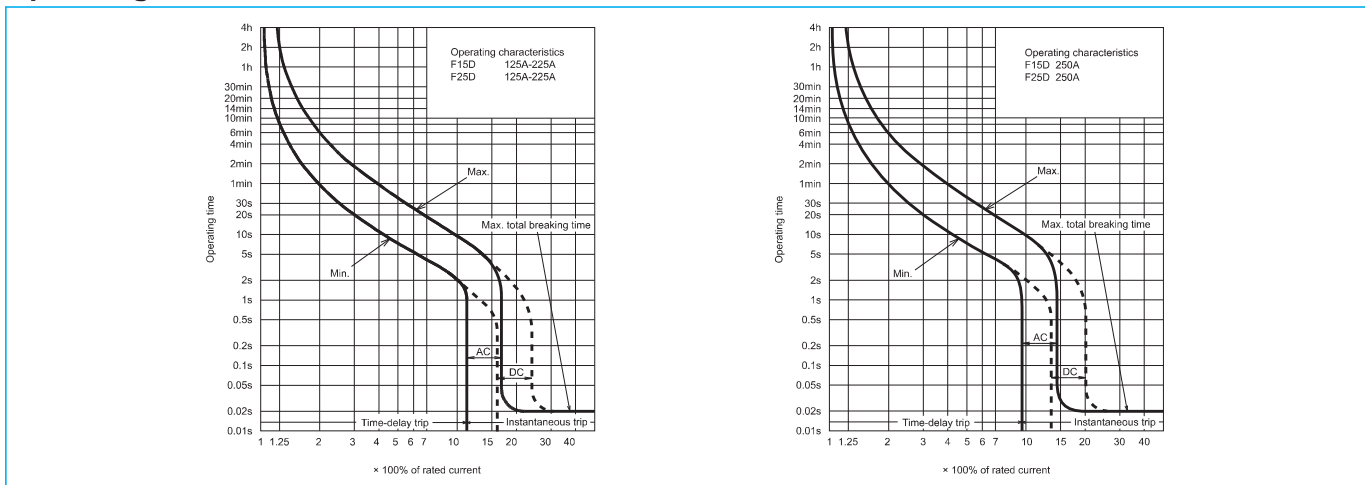

## Internal Accessories

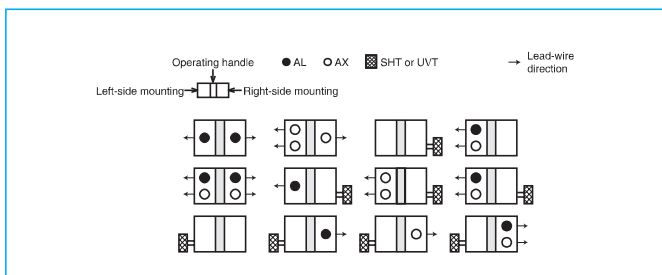

## Temperature Compensation Curve

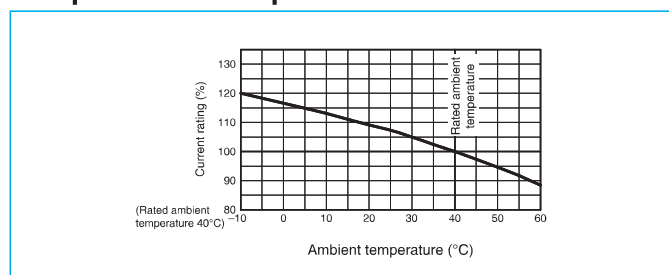

# F15D / F25D Dimensional Drawings

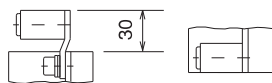
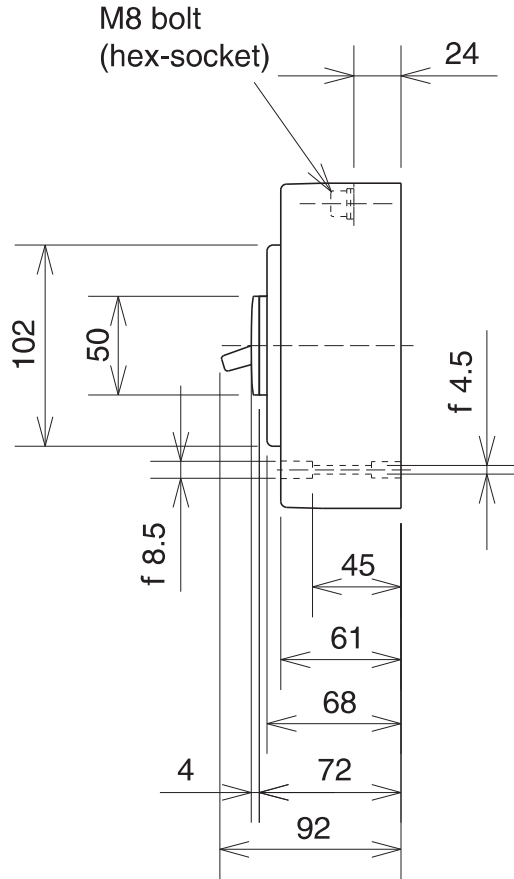
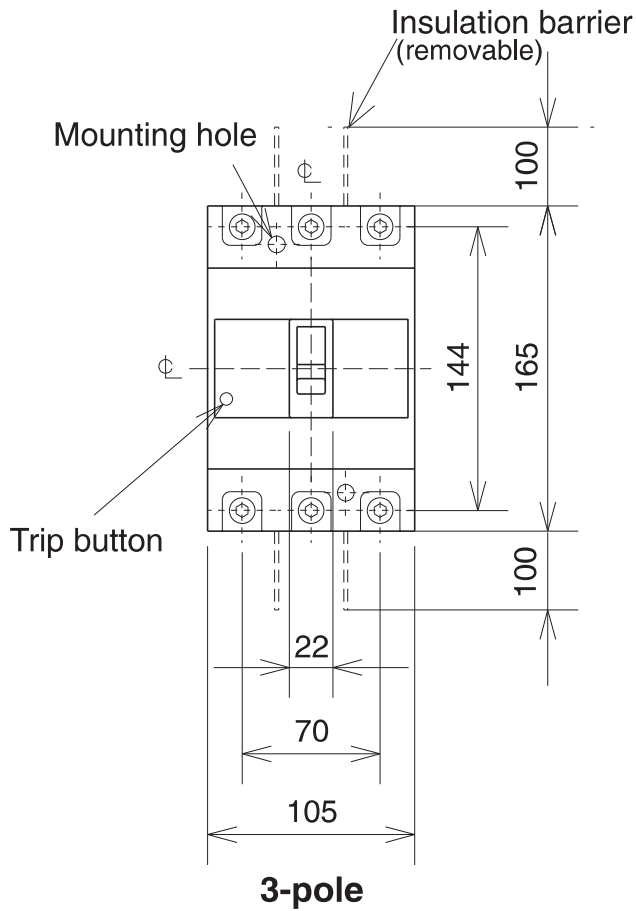

Solderless terminal  
for wire size  
125-175A 14-95mm<sup>2</sup>  
200-250A 70-125mm<sup>2</sup>  
Wire connection

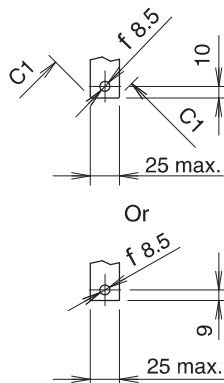

(Conductor thickness  
t=7 max.)

**Conductor drilling  
for direct connection**

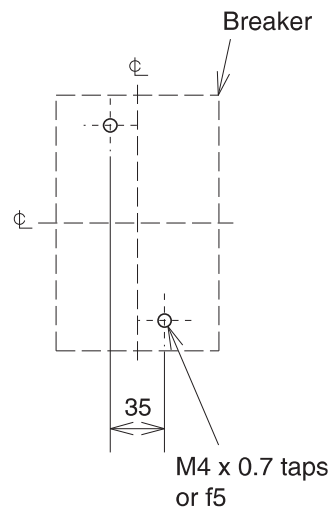

**3-pole**

**Drilling plan**



# G35D Data Sheet



Model		G35D		
Rated current In (A)		16, 20, 32 40, 50, 63, 80, 100		
Number of poles		3		
Rated insulation voltage Ui (V)		690		
Rated short-circuit breaking capacity (kA)	IEC 60947-2 (Icu/Ics)	AC	690V	10/8
			525V	22/11
		DC	500V	22/11
			415V	35/35
Standard attached parts (front connection)		Mounting screw: M4×0.7×55 3P: 2pcs Insulation barrier: 3P: 2pcs		

## Operating Characteristics

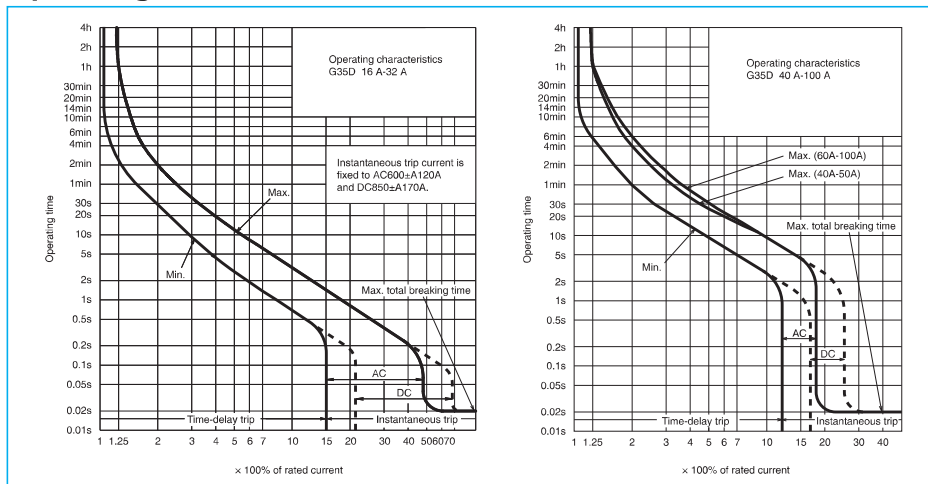

## Internal Accessories

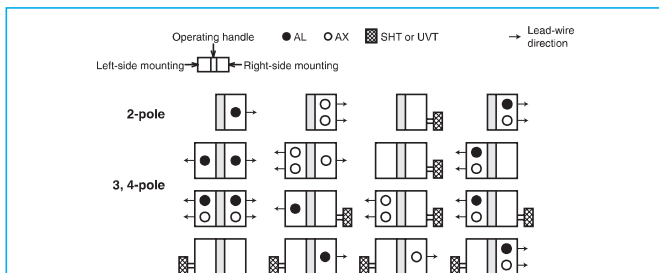

## Temperature Compensation Curve

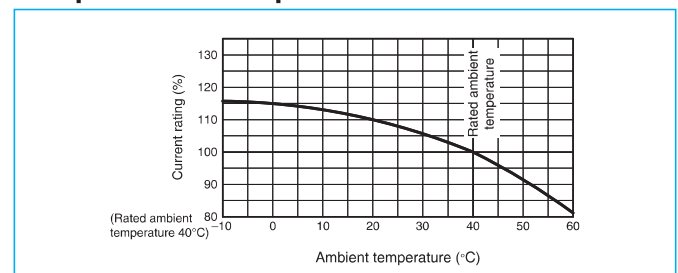

# G35D Dimensional Drawings

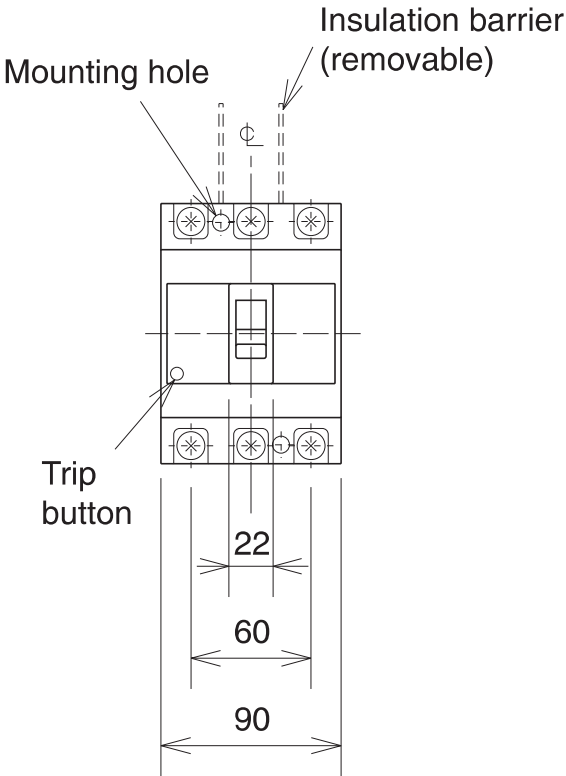

**3-pole**

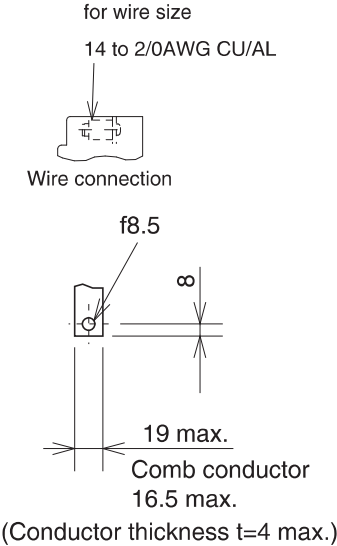
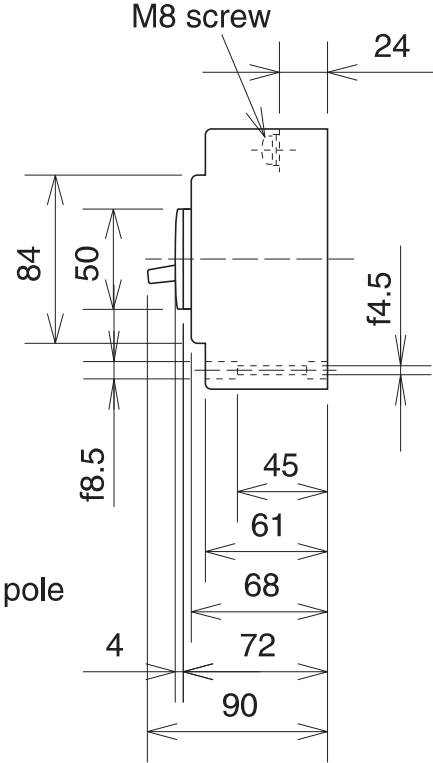

**Conductor drilling  
for direct connection**

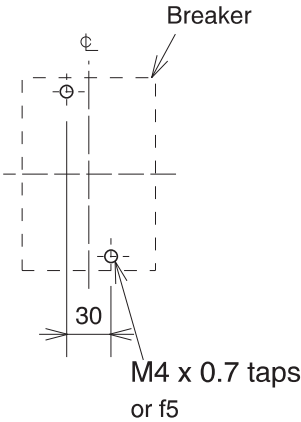

**3-pole**

**Drilling plan**

# F35D Data Sheet



Model		F35D	
Rated current I <sub>n</sub> (A)		125, 150, 160, 175 200, 225, 250	
Number of poles		3	
Rated insulation voltage U <sub>i</sub> (V)		690	
Rated short-circuit breaking capacity (kA)	IEC 60947-2 (I <sub>cu</sub> /I <sub>cs</sub> )	AC 690V	10/8
		525V	35/35
		500V	35/35
		415V	35/35
		DC 250V	40/40
Standard attached parts (front connection)		Mounting screw: M4×0.7×55 (3P: 2pcs) Insulation barrier: 3P: 4pcs	

## Operating Characteristics

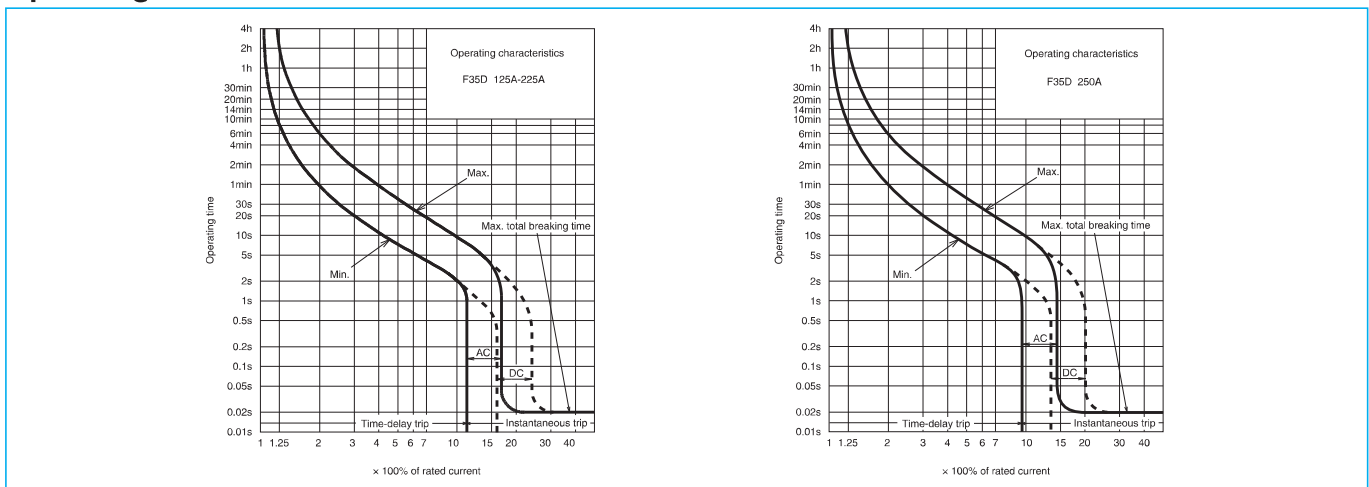

## Internal Accessories

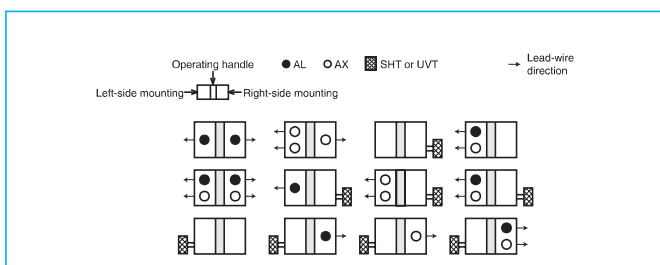

## Temperature Compensation Curve

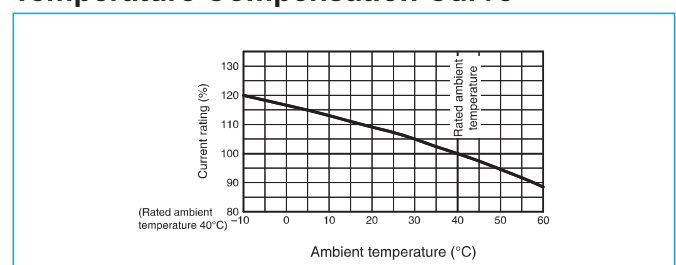

# F35D

## Dimensional Drawings

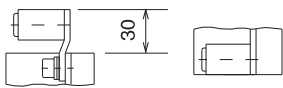
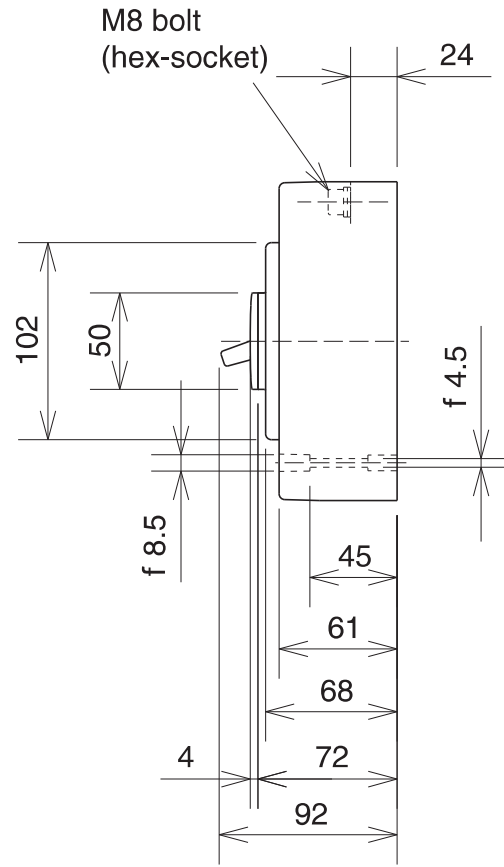
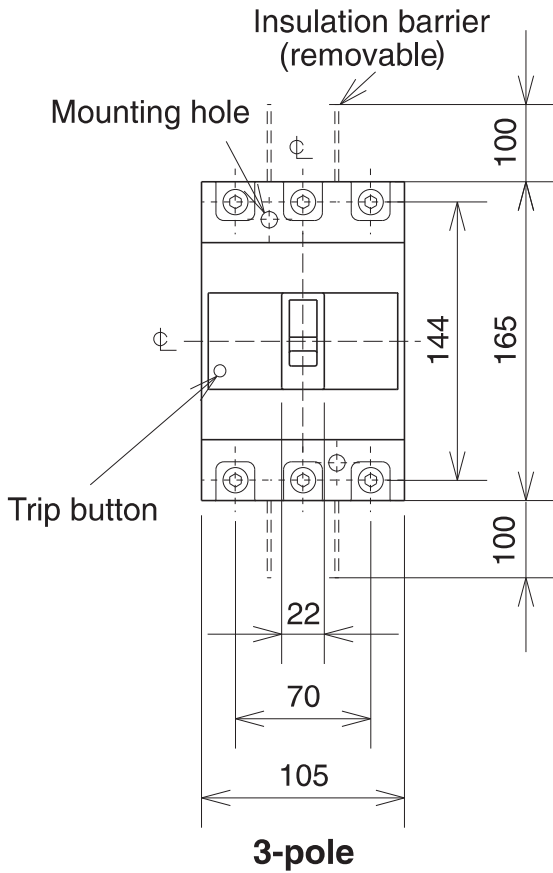

Solderless terminal  
for wire size  
125-175A 14-95mm<sup>2</sup>  
200-250A 70-125mm<sup>2</sup>  
Wire connection

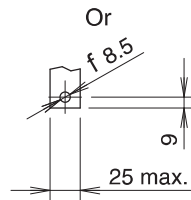
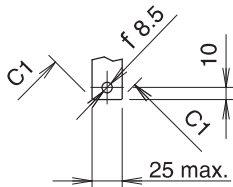

(Conductor thickness  
t=7 max.)

**Conductor drilling  
for direct connection**

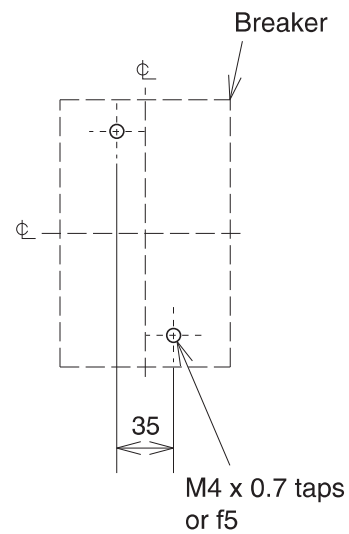

**3-pole**

# F65DV Data Sheet



Model		F65DV		
Rated current In (A)		20-25, 32-40, 45-63, 70-100, 90-125, 125-160, 175-250		
Number of poles		3		
Rated insulation voltage Ui (V)		690		
Rated short-circuit breaking capacity (kA)	IEC 60947-2 (Icu/lcs)	AC	690V	20/20
			525V	35/35
			500V	50/50
			415V	65/65
DC	300V	40/40		

## Operating Characteristics

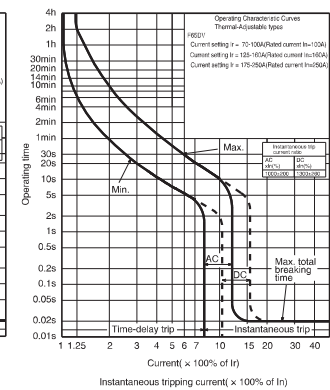
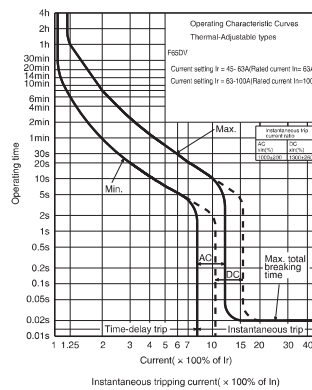
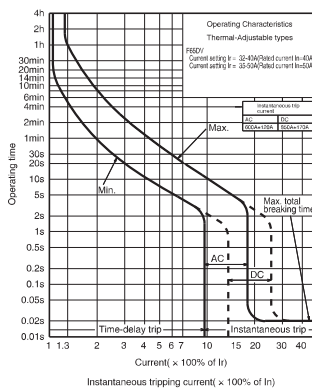
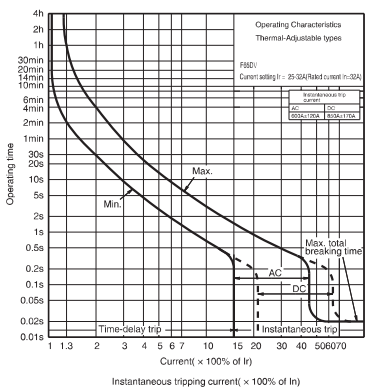

## Internal Accessories

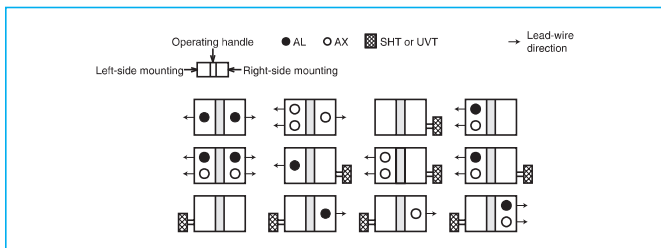

## Temperature Compensation Curve

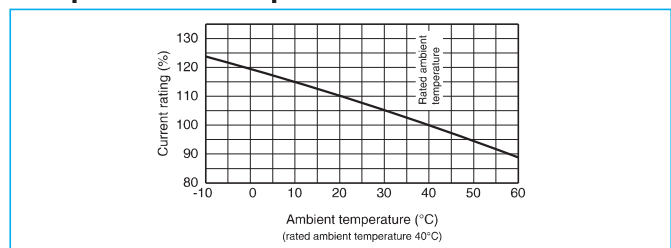

# F65DV

## Dimensional Drawings

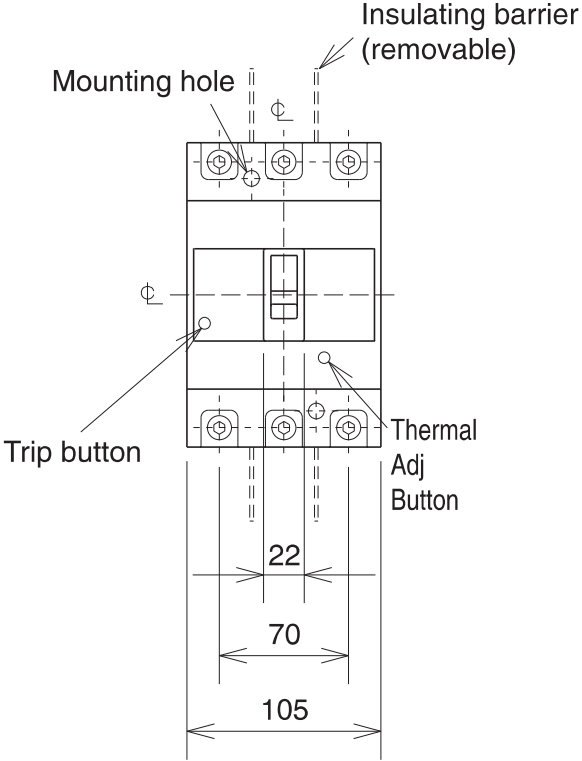

**3-pole**

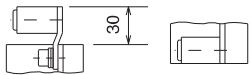
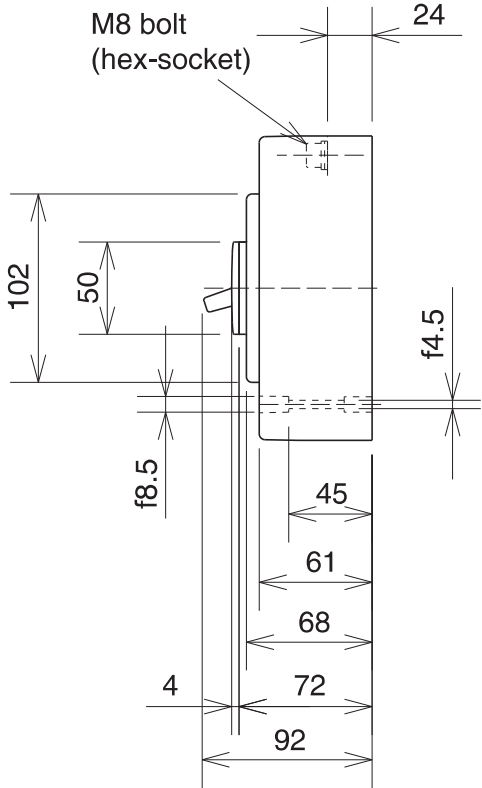

Solderless terminal  
for wire size  
125-175A 14-95mm<sup>2</sup>  
200-250A 70-125mm<sup>2</sup>  
Wire connection

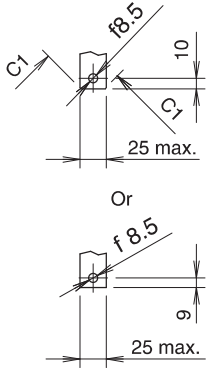

(Conductor thickness t=7 max.)

**Conductor drilling  
for direct connection**

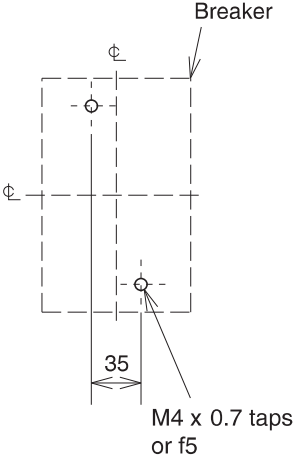

**3-pole**

**Drilling plan**

# K25D Data Sheet



Model		K25D		
Rated current I <sub>n</sub> (A)		250 300 350 400		
Number of poles		3		
Rated insulation voltage U <sub>i</sub> (V)		690		
Rated short-circuit breaking capacity (kA)	IEC 60947-2 (Icu/Ics)	AC	690V	-
			500V	15/8
			440V	25/13
			400V	36/18
			230V	50/25
		DC	250V	20/10
Standard attached parts		Front connection	Mounting screw: M6×60 (4pcs) Insulating barrier: 3P: 4pcs	

## Operating Characteristics

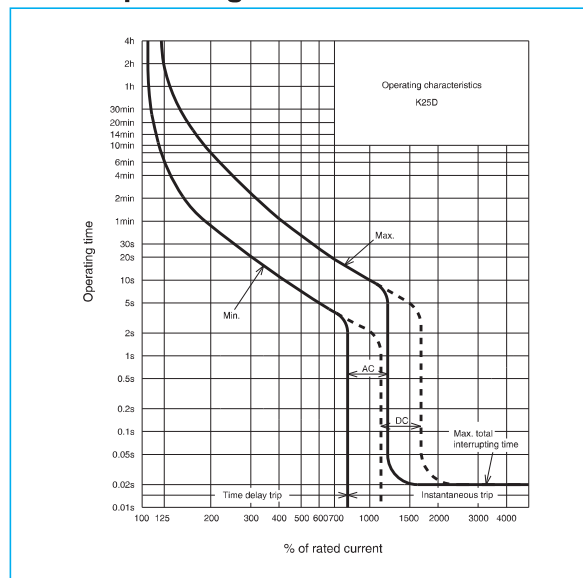

## Internal Accessories

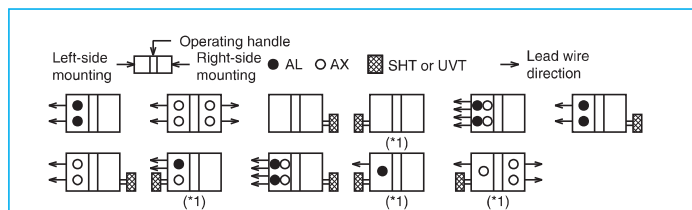

Note \*1 Right-side mounting is standard of SHT and UVT. Specify separately for left-side mounting.  
Remark: 1. Refer to page 106.

## Temperature Compensation Curve

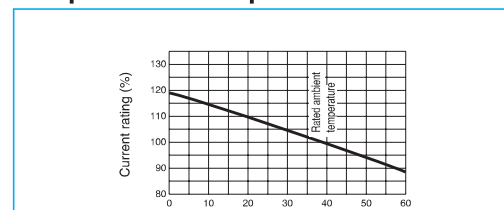

# K25D Dimensional Drawings

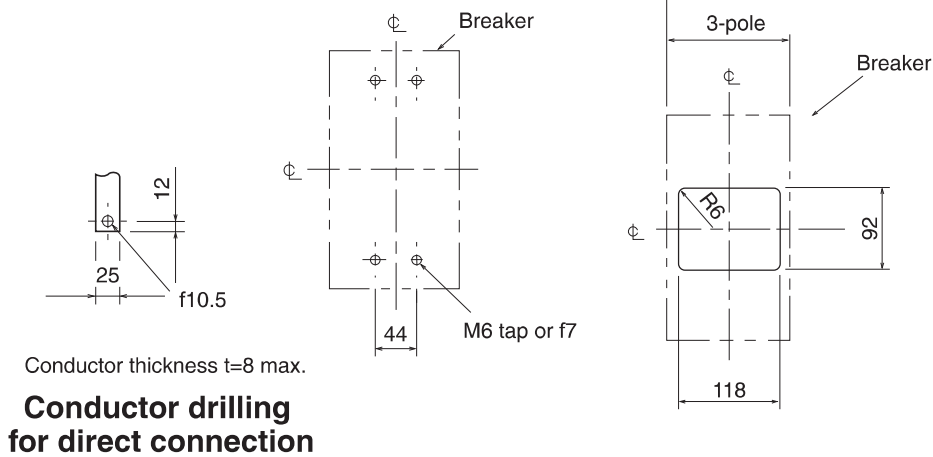
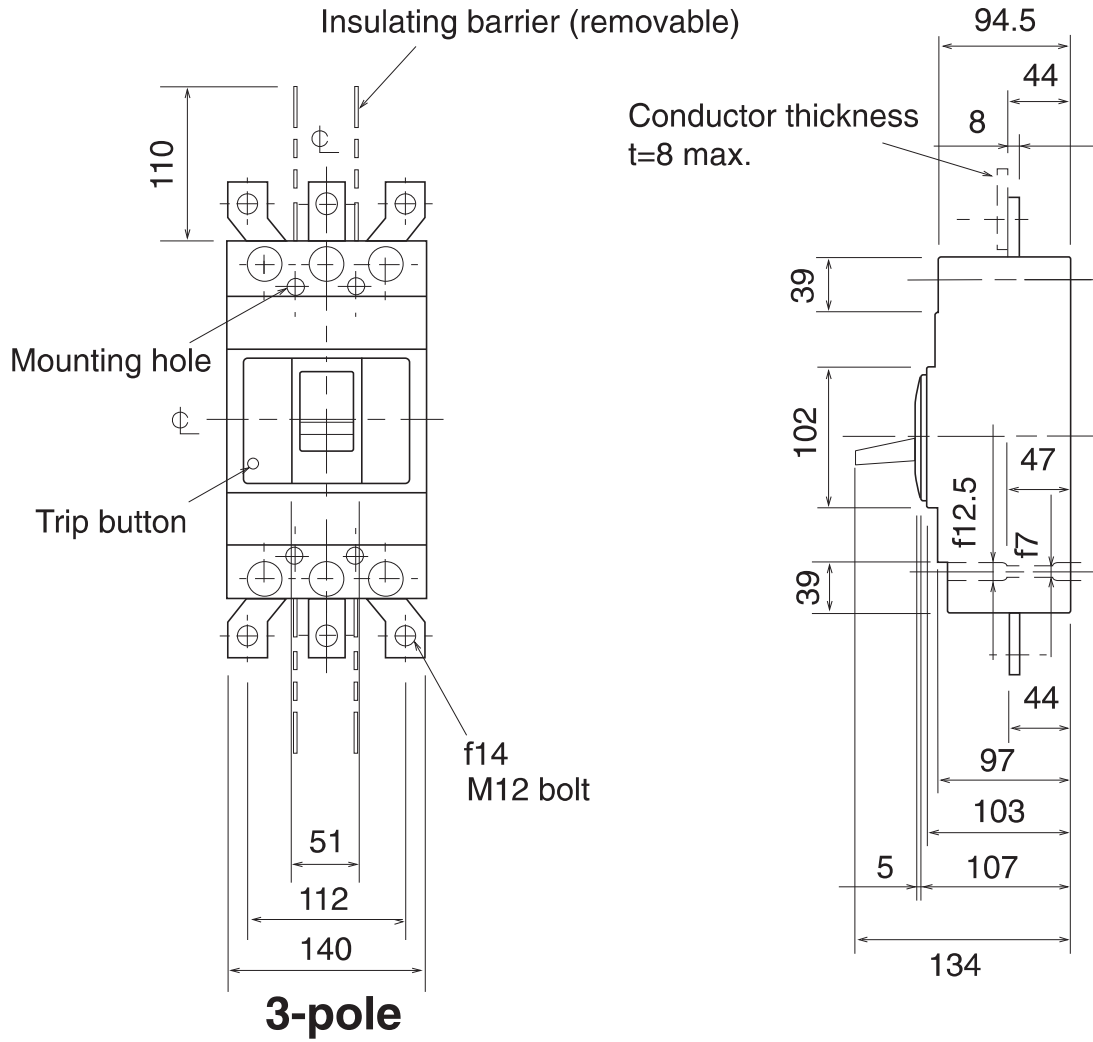

**3-pole  
Drilling plan**

1.0mm clearance on each side of the handle frame.

**Front-panel cutout**



# K35D Data Sheet



Model		K35D	K35D		
Rated current In (A)		250, 300, 350, 400	500 / 630		
Number of poles		3	3		
Rated insulation voltage Ui (V)		690	690		
Rated short-circuit breaking capacity (kA)	IEC 60947-2 (Icu/Ics)	AC	690V	10/10	-
			525V	30/18	-
			500V	30/22	22/6
			440V	-	36/18
			415V	35/35	36/18
			400V	-	36/18
			380V	-	40/20
		DC	250VDC	40/40	20/10
Standard attached parts		Front connection	Mounting screw: M6×60 (4pcs) Insulating barrier: 3P: 4pcs		

## Operating Characteristics

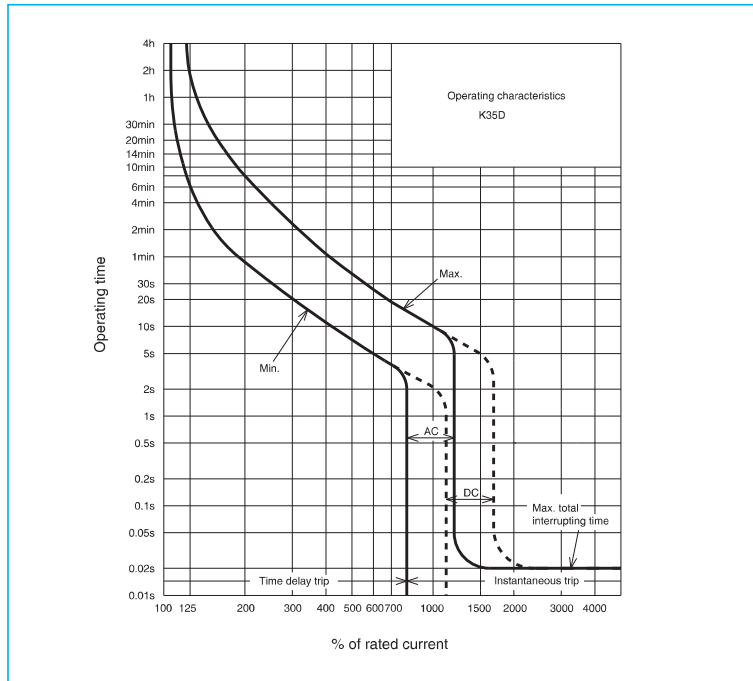

## Internal Accessories

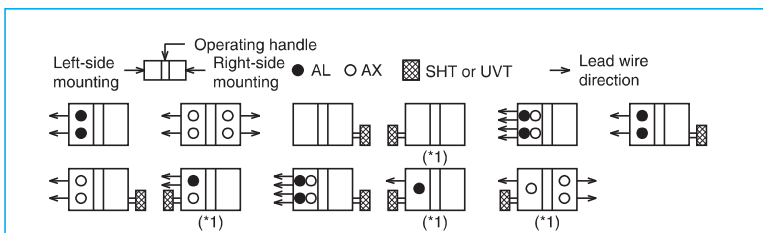

Note \*1 Right-side mounting is standard of SHT and UVT. Specify separately for left-side mounting.  
Remark: 1. Refer to page 106.

## Temperature Compensation Curve

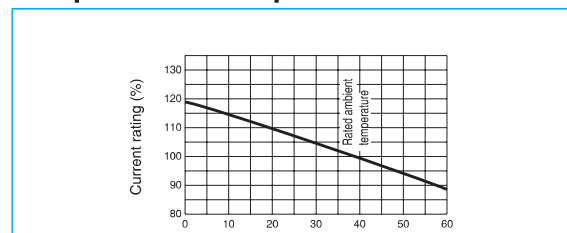

# K35D Dimensional Drawings

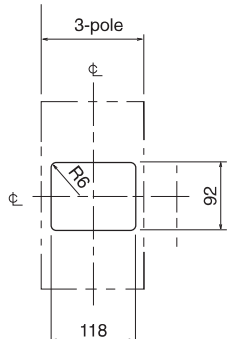
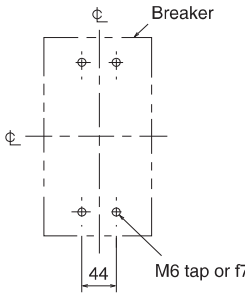
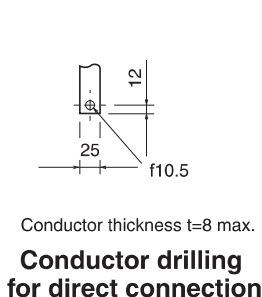
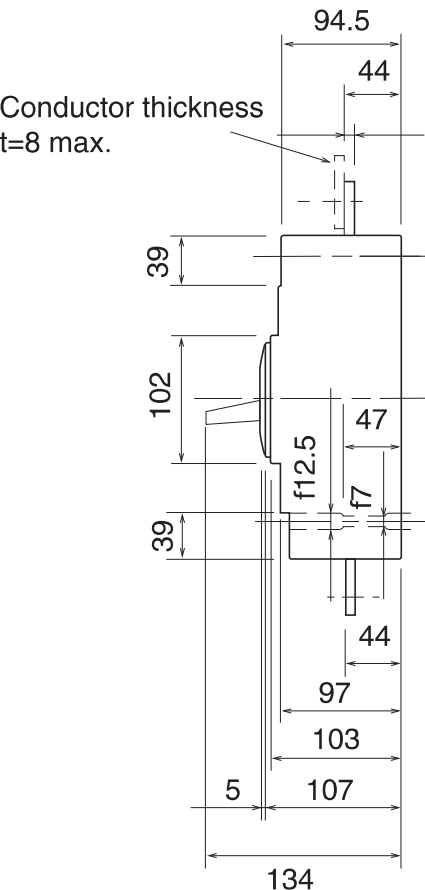
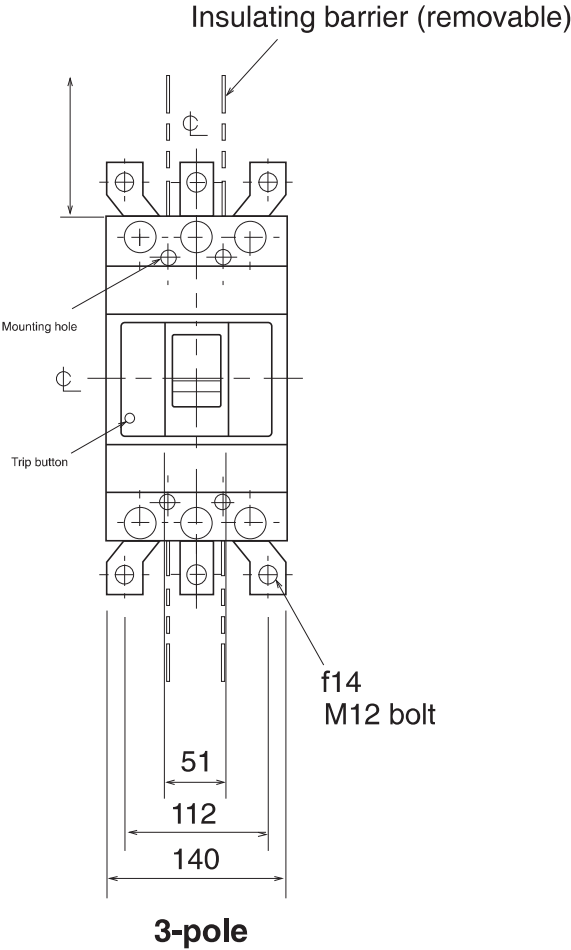

1.0mm clearance on each side of the handle frame.

# K35DE Data Sheet



Model		K35DE		
Rated current I <sub>n</sub> (A)		200 - 400 Adjustable		
Number of poles		3		
Rated insulation voltage U <sub>i</sub> (V)		690		
Rated short-circuit breaking capacity (kA)	IEC 60947-2 (Icu/Ics)	AC	690V	10/10
			525V	30/18
			500V	30/22
			415V	35/35
Standard attached parts		Front connection	Mounting screw: M6×72 (4pcs) Insulating barrier: (3P: 4pcs)	

## Operating Characteristics

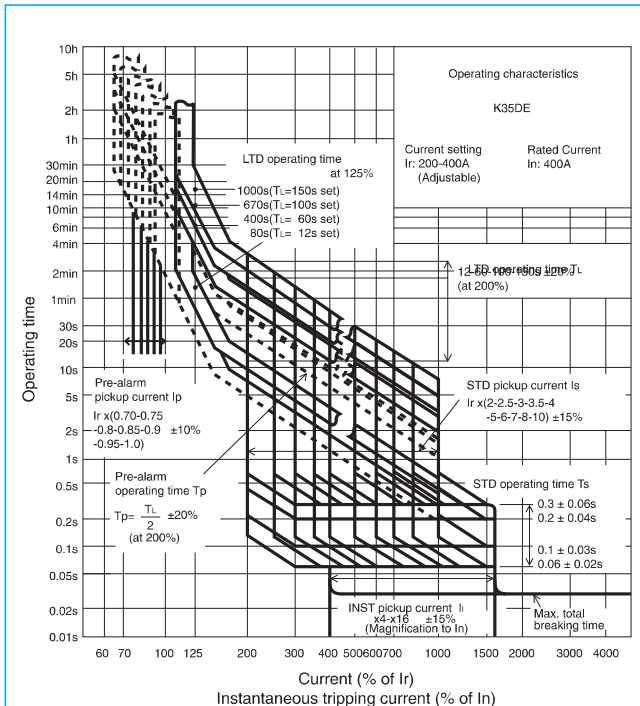

## Internal Accessories

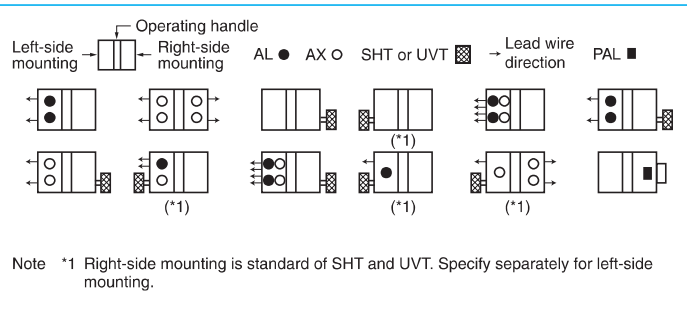

## Current Reducing Curve

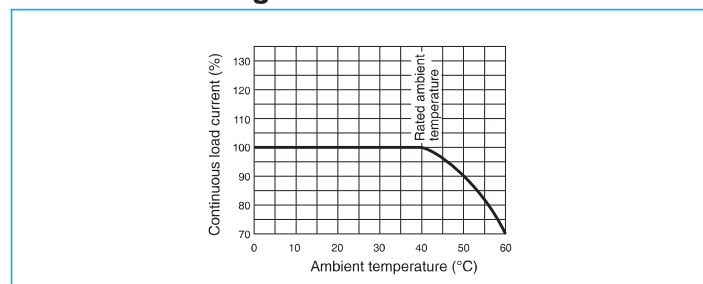

# K35DE

## Dimensional Drawings

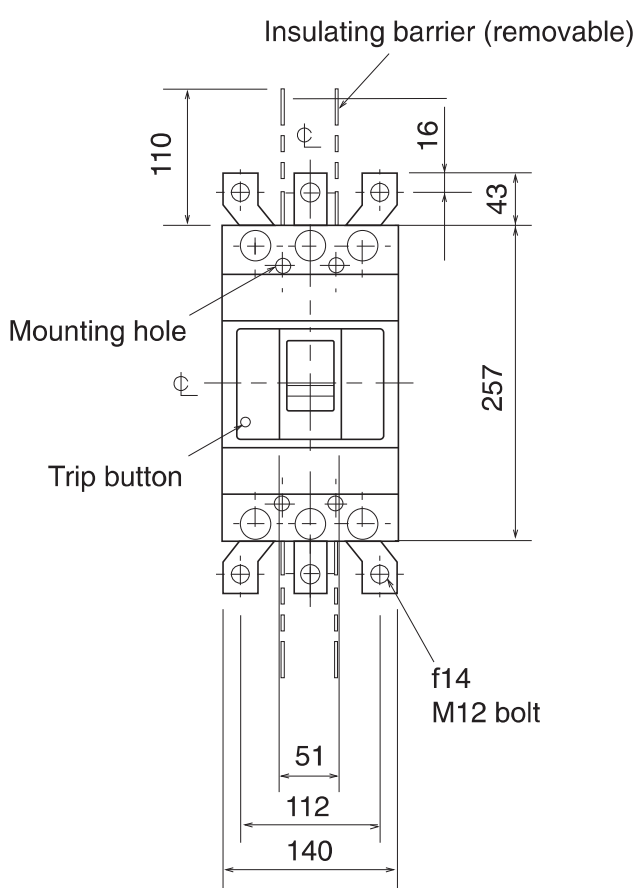

**3-pole**

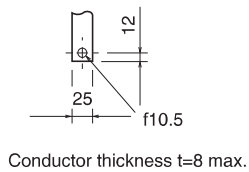
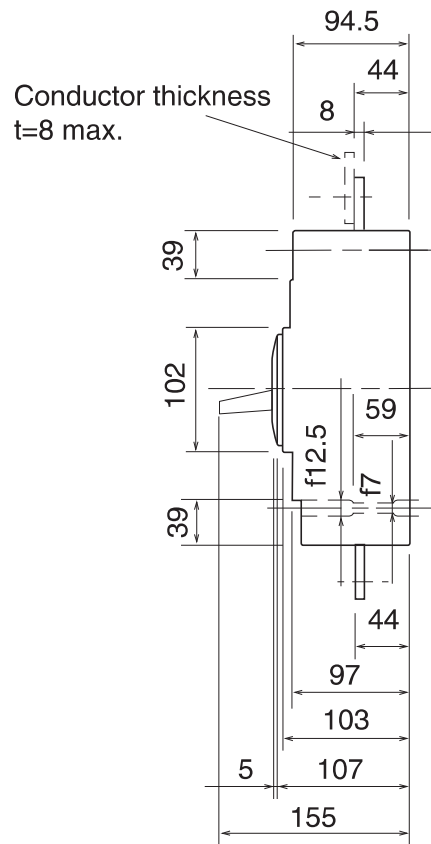

**Conductor drilling  
for direct connection**

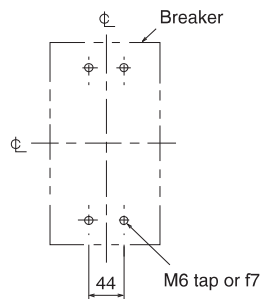

**3-pole  
Drilling plan**

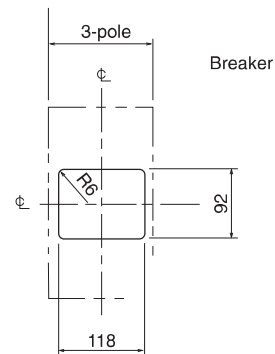

1.0mm clearance on each side of the handle frame.

**Front-panel cutout**

# K50D Data Sheet



Model		K50D		
Rated current In (A)		500, 630		
Number of poles		3		
Rated insulation voltage Ui (V)		690		
Rated short-circuit breaking capacity (kA)	IEC 60947-2 (Icu/Ics)	AC	690V	10/10
			525V	35/26
			500V	42/42
			415V	50/50
			230V	85/85
	DC (*1)	250V	40/40	
Standard attached parts		Front connection	Mounting screw: M6×72 (4pcs) Insulating barrier: (2P: 2pcs, 3P: 4pcs, 4P: 6pcs)	
		Rear connection	Mounting screw: M6×85 (4pcs)	

## Operating Characteristics

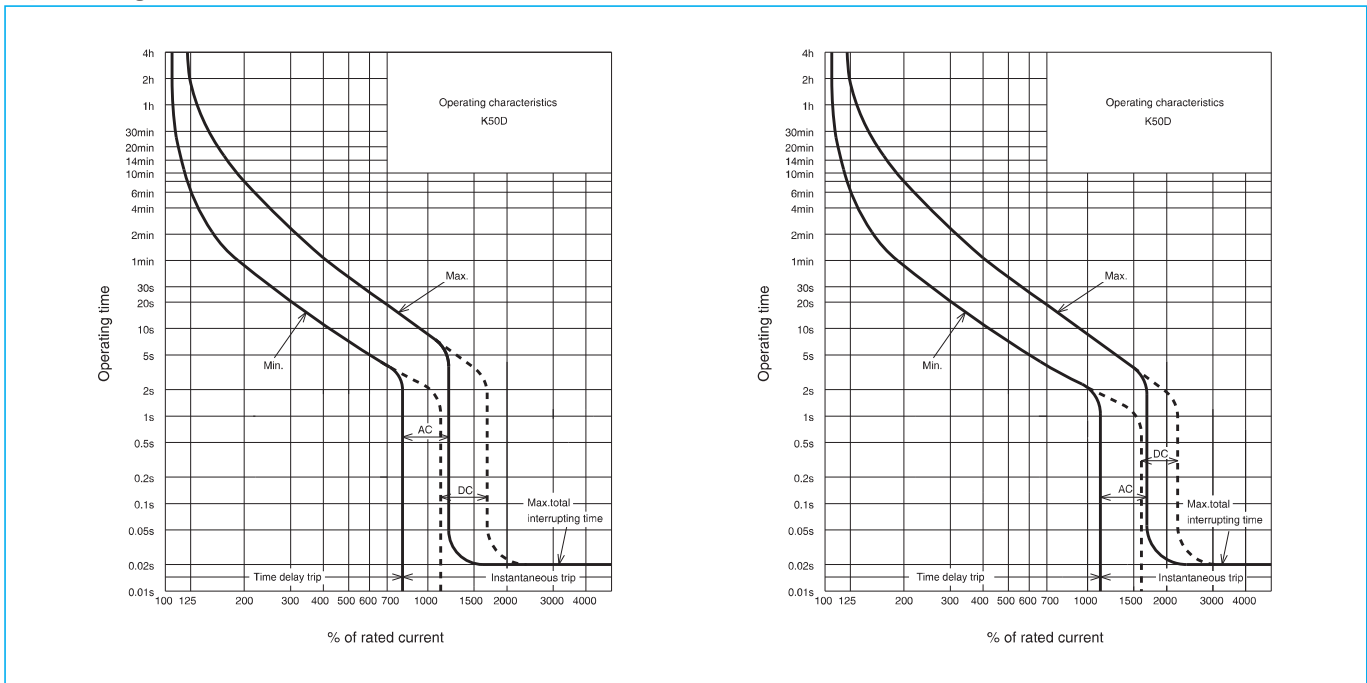

## Internal Accessories

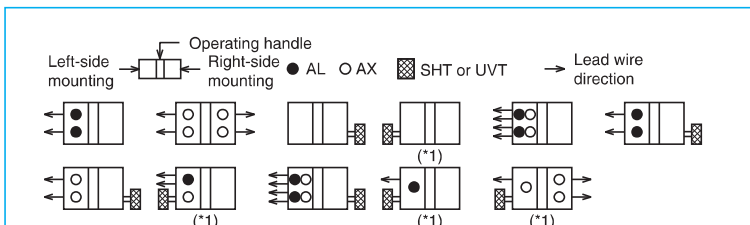

Note \*1 Right-side mounting is standard of SHT and UVT. Specify separately for left-side mounting.

## Temperature Compensation Curve

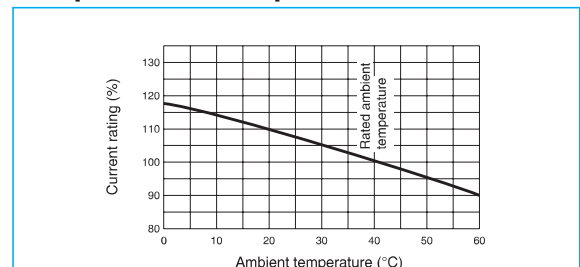

# K50D

## Dimensional Drawings

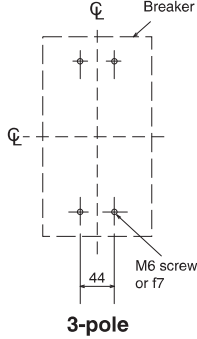
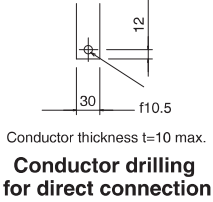
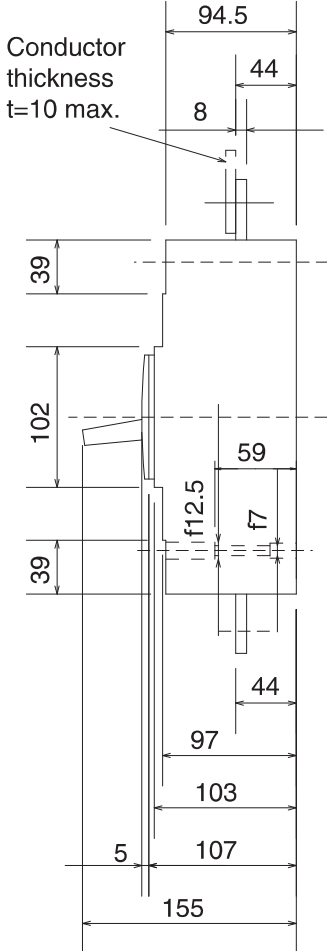
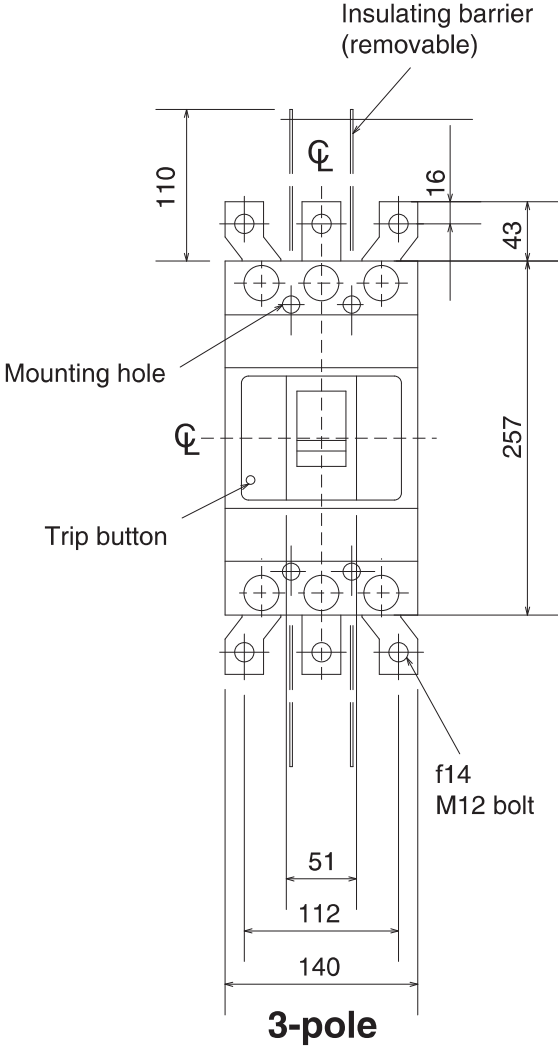

**Drilling plan**

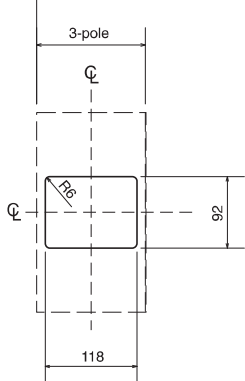

1.0mm clearance on each side of handle.  
**Front-plate cutout**

# K50DE Data Sheet



Model		K50DE		
Rated current I <sub>n</sub> (A)		300 - 630 Adjustable		
Number of poles		3		
Rated insulation voltage U <sub>i</sub> (V)		690		
Rated short-circuit breaking capacity (kA)	IEC 60947-2 (I <sub>cu</sub> /I <sub>cs</sub> )	AC	690V	10/10
			525V	35/26
			500V	40/30
			415V	50/50
			380V	50/50
Standard attached parts		Front connection Mounting screw: M6×72 (4pcs) Insulating barrier: (3P: 4pcs)		

## Operating Characteristics

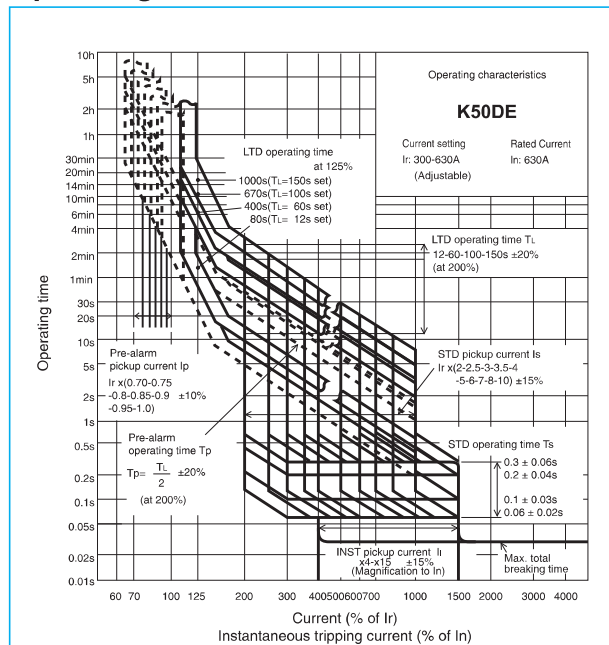

## Internal Accessories

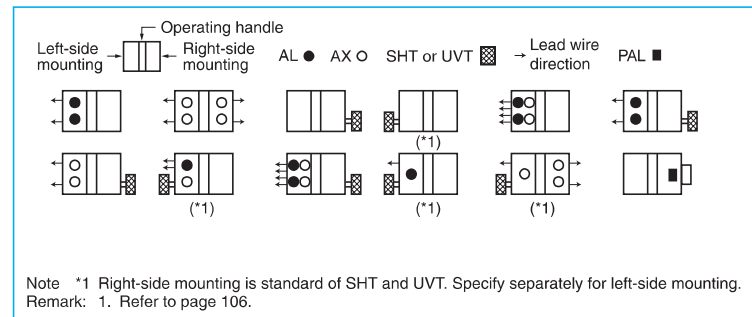

## Current Reducing Curve

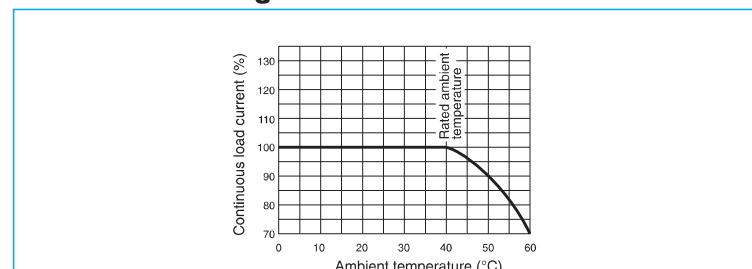

# K50DE

## Dimensional Drawings

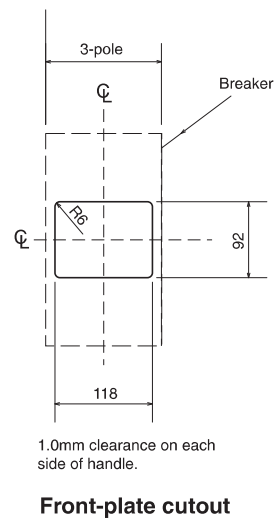
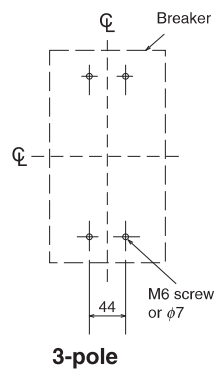
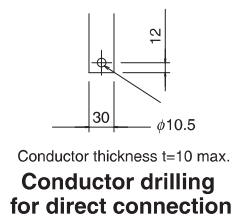
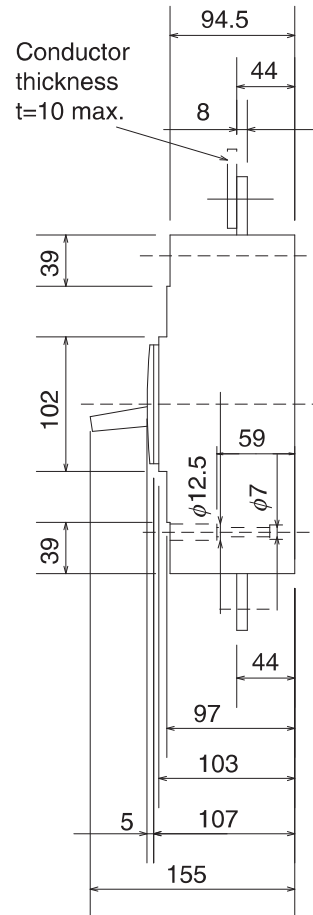
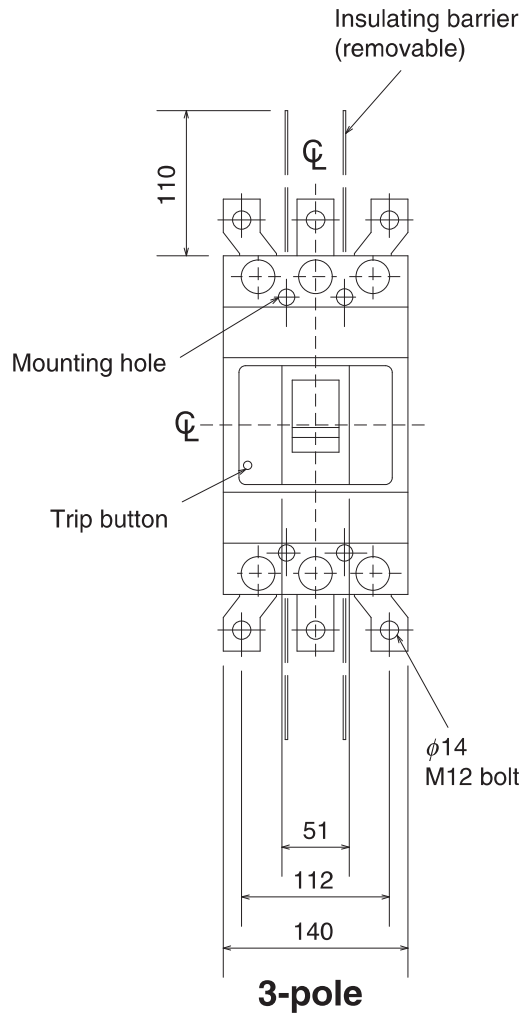



# K70DE Data Sheet



Model		K70DE		
Rated current In (A)		300 - 630 Adjustable		
Number of poles		3		
Rated insulation voltage Ui (V)		690		
Rated short-circuit breaking capacity (kA)	IEC 60947-2 (Icu/Ics)	AC	690V	35/18
			500V	50/50
			415V	70/70
			380V	70/70
Standard attached parts		Front connection	Mounting screw: M6×72 (4pcs) Insulating barrier: (3P: 4pcs)	

## Operating Characteristics

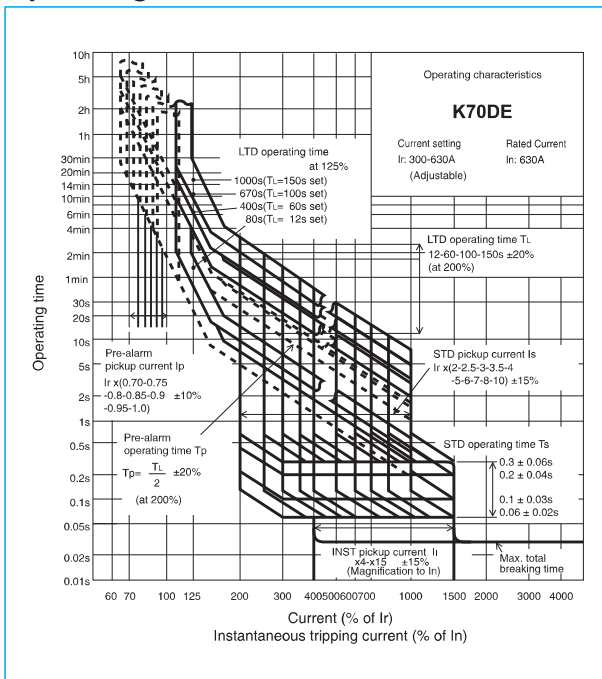

## Internal Accessories

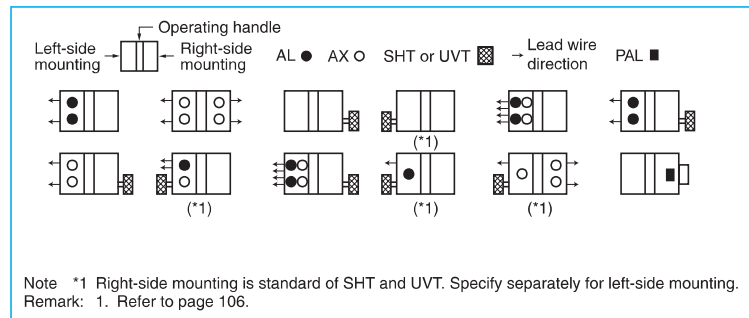

## Current Reducing Curve

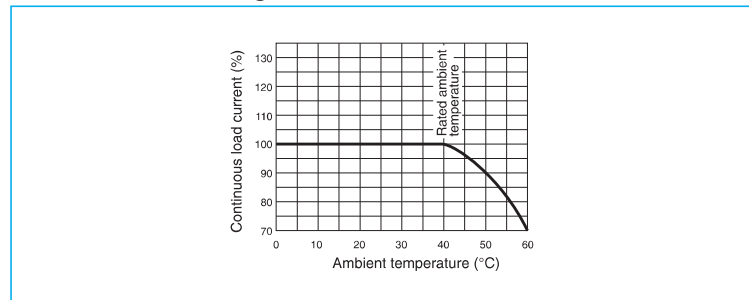

# K70DE

## Dimensional Drawings

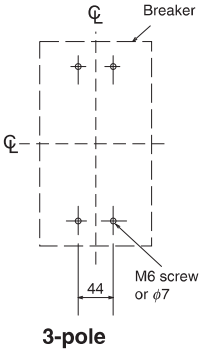
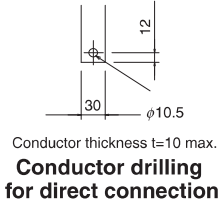
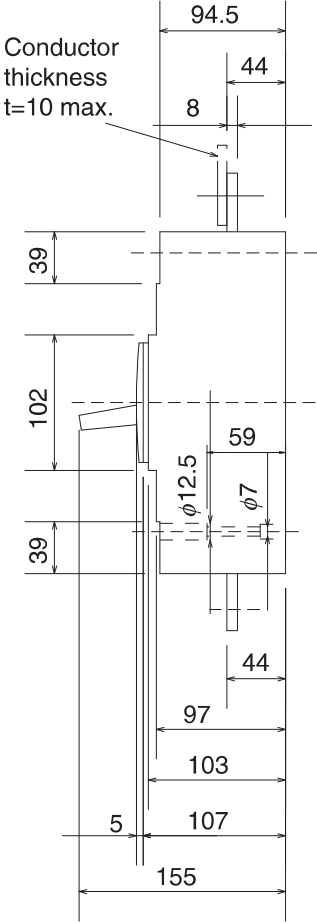
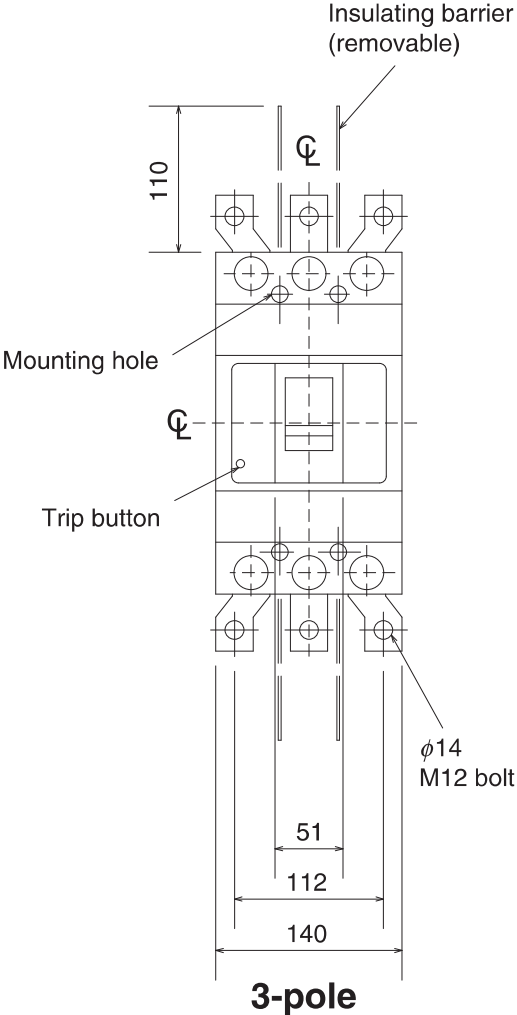

Drilling plan

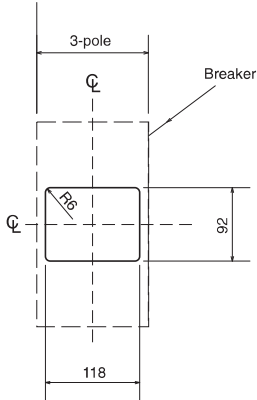

1.0mm clearance on each side of handle.

Front-plate cutout

# L35DE800

## Data Sheet



Model		L35DE800		
Rated current $I_n$ (A)		400 - 800 Adjustable		
Number of poles		3		
Rated insulation voltage $U_i$ (V)		690		
Rated short-circuit breaking capacity (kA)	IEC 60947-2 (Icu/Ics)	AC	500V	22/6
			440V	36/18
			415V	36/18
			400V	36/18
			380V	40/20
230V	50/25			
Standard attached parts		Front connection	Mounting screw: M6×35 (4pcs) Insulating barrier: (3P: 2pcs)	

### Operating Characteristics

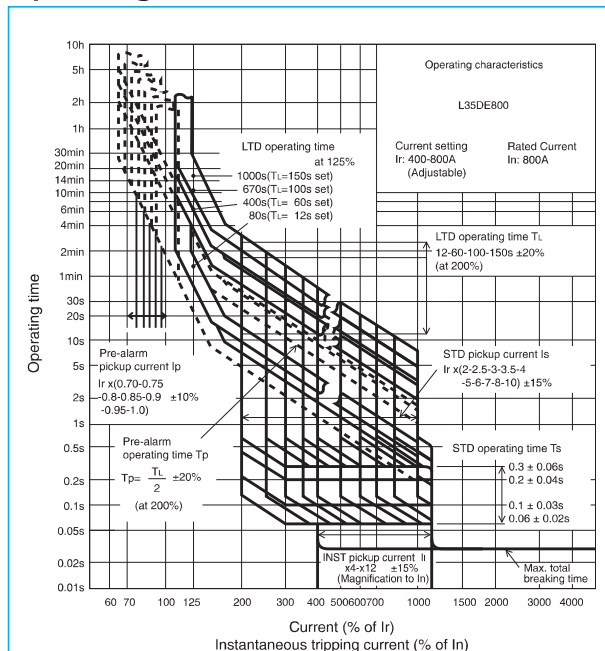

### Internal Accessories

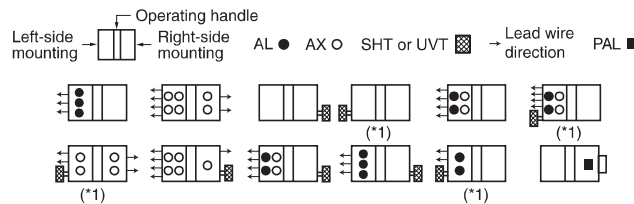

Note \*1 Right-side mounting is standard of SHT and UVT. Specify separately for left-side mounting.  
 Remark: 1. Refer to page 106.

### Current Reducing Curve

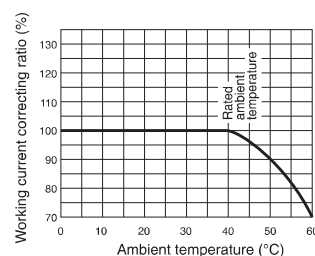

# L35DE800

## Dimensional Drawings

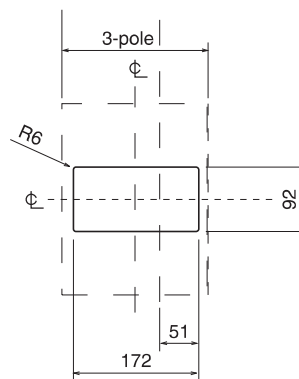
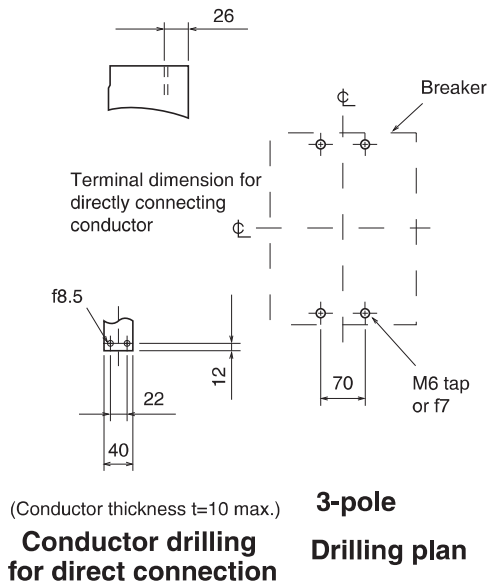
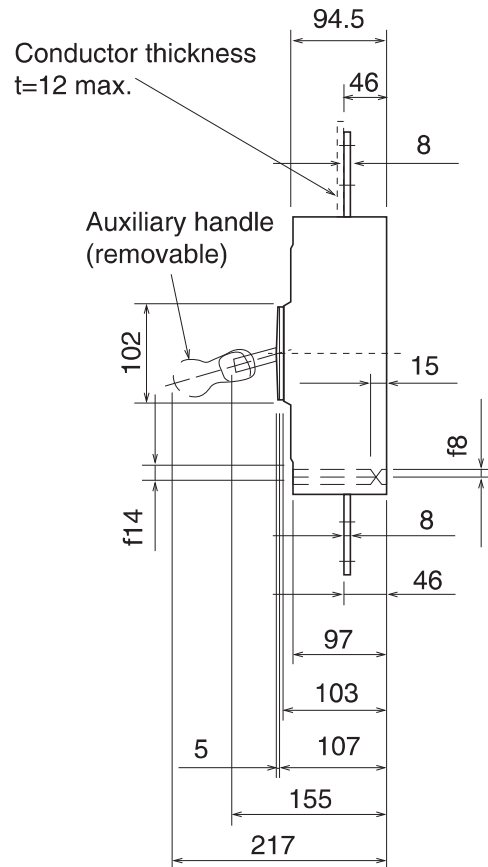
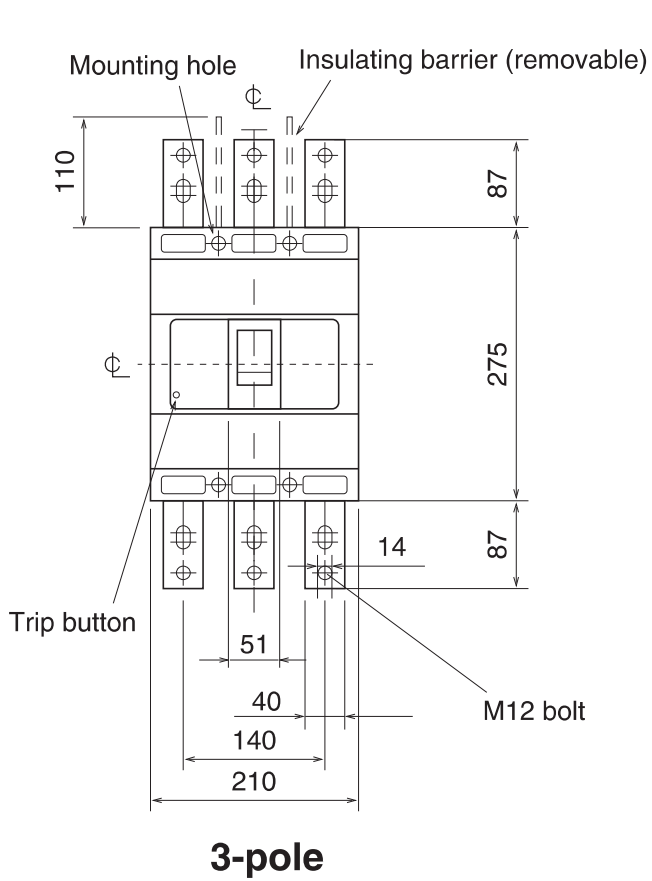

1.0mm clearance on each side of the handle frame.  
**Front-panel cutout**

# L70DE800

## Data Sheet



Model		L70DE800		
Rated current $I_n$ (A)		400-800 adjustable		
Number of poles		3		
Rated insulation voltage $U_i$ (V)		690		
Rated short-circuit breaking capacity (kA)	IEC 60947-2 (Icu/Ics)	AC	690V	15/15
			500V	50/50
			440V	65/65
			400V	70/70
			230V	100/100
Standard attached parts (4-pole models are provided with auxiliary handle.)		Front connection	Mounting screw: M6×35 (4pcs) Insulating barrier: (3P: 2pcs)	
		Rear connection	Mounting screw: M6×40 (4pcs)	

### Operating Characteristics

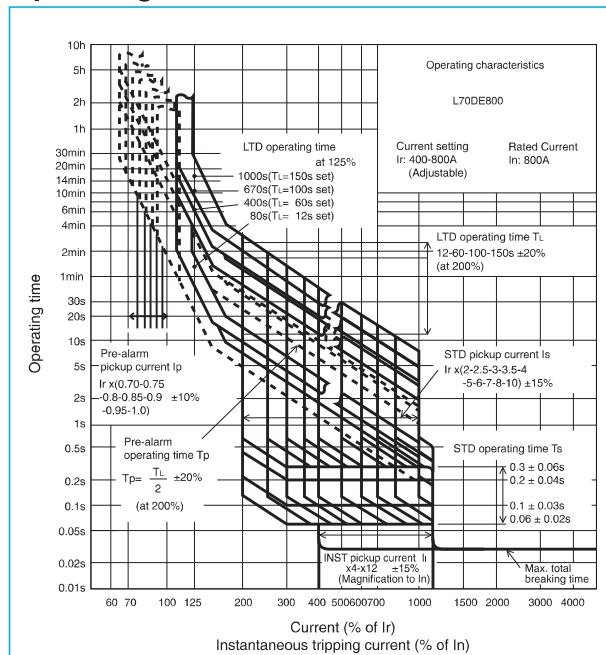

### Internal Accessories

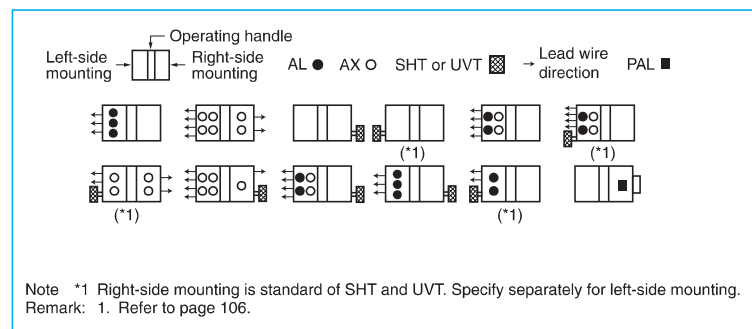

### Current Reducing Curve

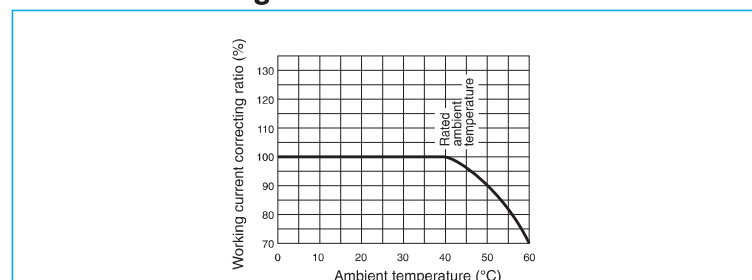

# L70DE800

## Dimensional Drawings

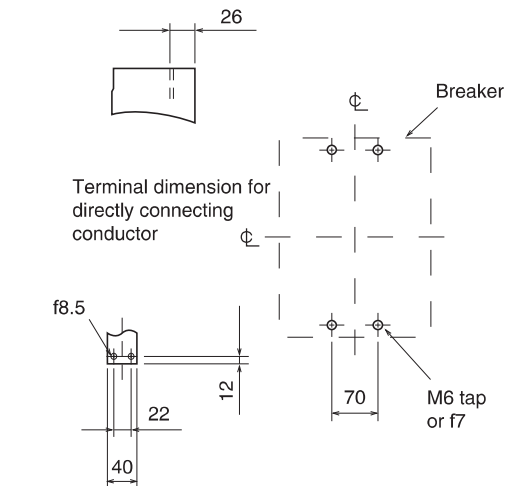
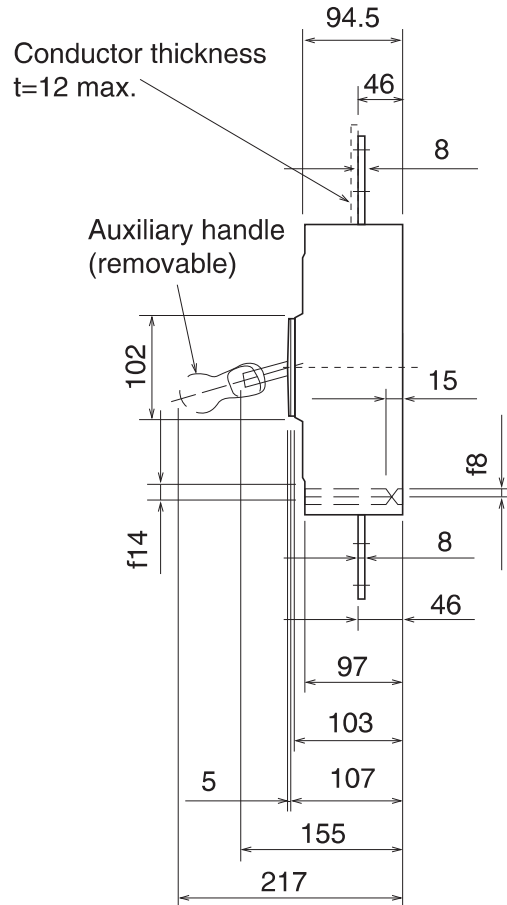
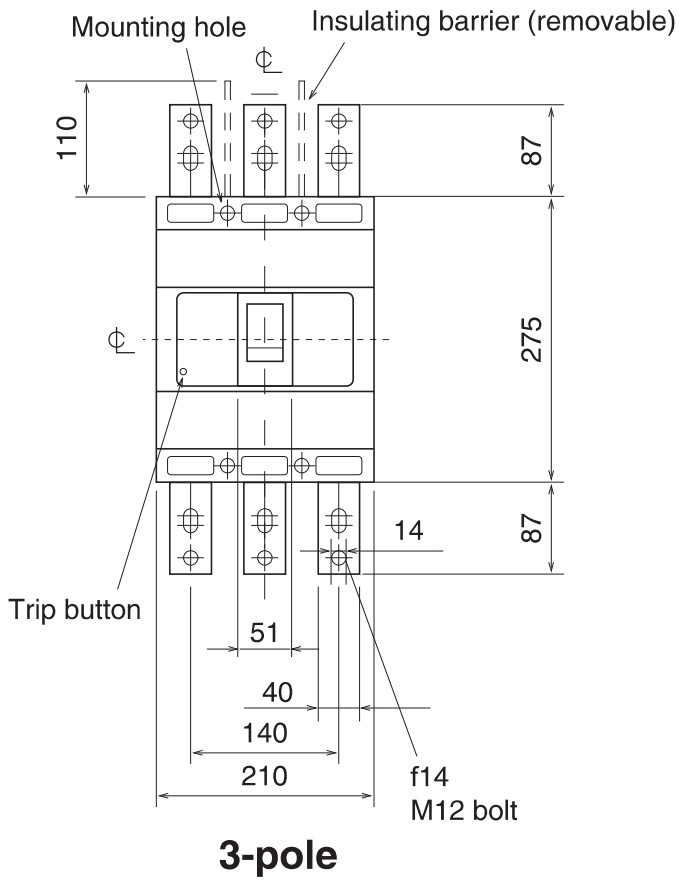

(Conductor thickness  $t=10$  max.)  
**Conductor drilling for direct connection**

**3-pole**  
**Drilling plan**

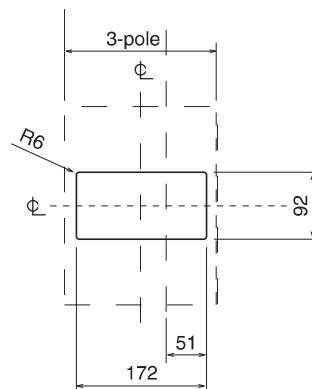

1.0mm clearance on each side of the handle frame.

**Front-panel cutout**

# N85DE1000 N85DE1250 Data Sheet



Model		N85DE1000	N85DE1250		
Rated current $I_n$ (A)		500–1000 Adjustable	600–1250 Adjustable		
Number of poles		3	3		
Rated insulation voltage $U_i$ (V)		690	690		
Rated short-circuit breaking capacity (kA)	IEC 60947-2 ( $I_{cu}/I_{cs}$ )	AC	690V	25/13	25/13
			500V	65/33	65/33
			440V	85/43	85/43
			400V	85/43	85/43
			230V	125/63	125/63
Standard attached parts		Front connection	Mounting screw: M8×40 (4pcs) Insulating barrier: (3P: 2pcs) Auxiliary handle: (1pc)		

## Operating Characteristics

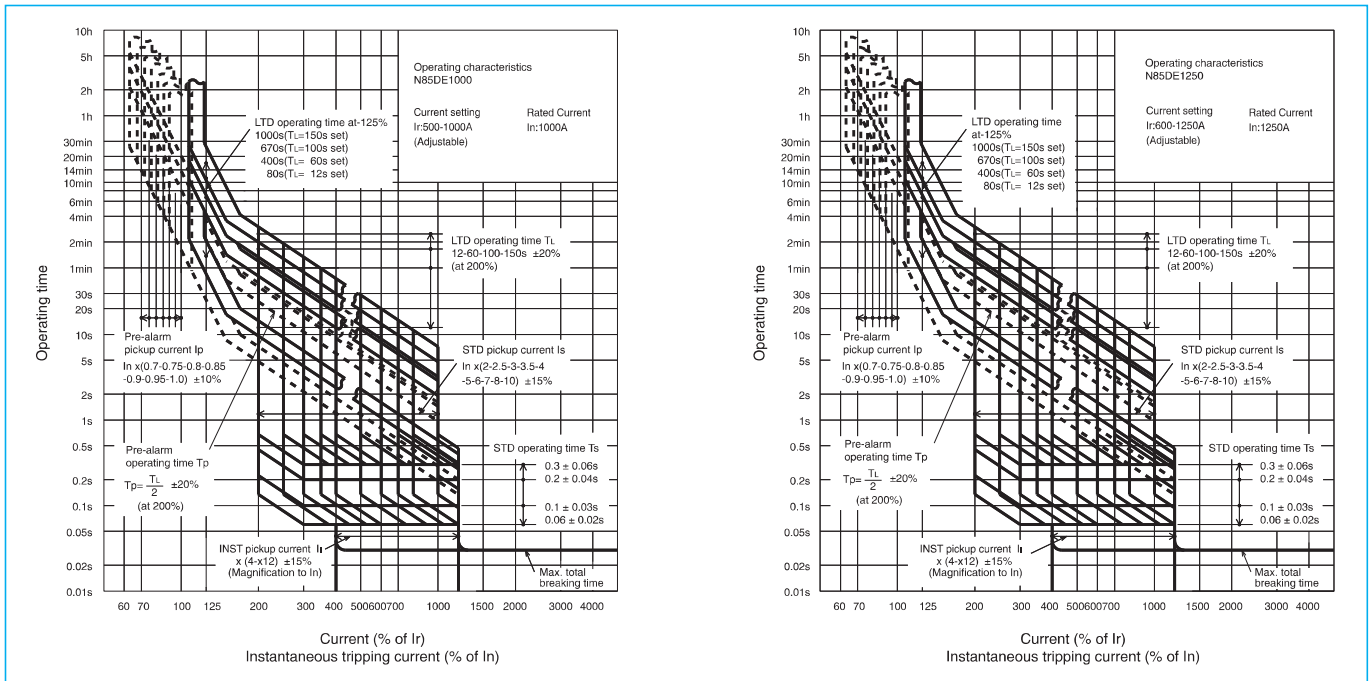

## Internal Accessories

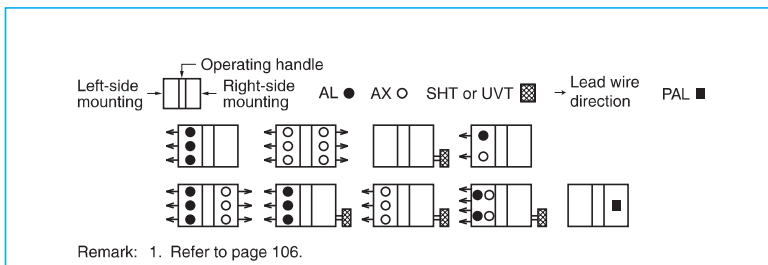

## Current Reducing Curve

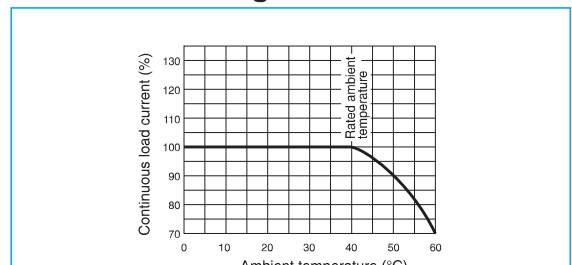

N85DE1000  
N85DE1250

# Dimensional Drawings

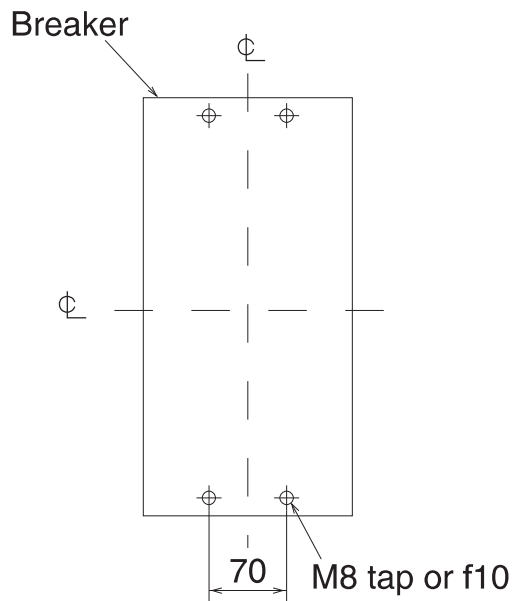
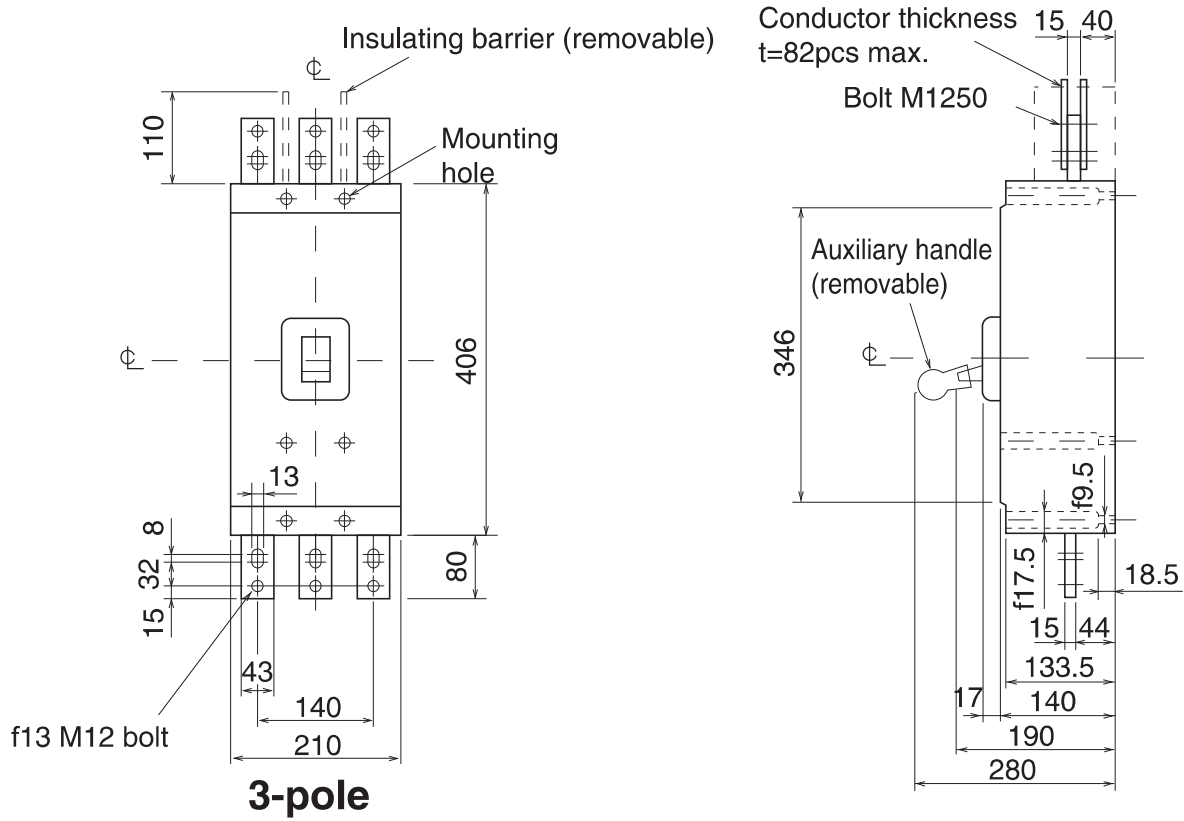

## Drilling plan 3 pole



# N85DE1600

## Data Sheet



Model			N85DE1600	
Rated current $I_n$ (A)			Adjustable 800-1600	
Number of poles			3	
Rated insulation voltage $U_i$ (V)			690	
Rated short-circuit breaking capacity (kA)	IEC 60947-2 ( $I_{cu}/I_{cs}$ )	AC	690V	25/13
			500V	65/33
			440V	85/43
			415V	85/43
			400V	125/63
Standard attached parts		Front connection	Mounting screw: M8 × 40 (4pcs) Insulating barrier: (3P: 2pcs, 4P: 3pcs) Auxiliary handle: (1pc)	

### Operating Characteristics

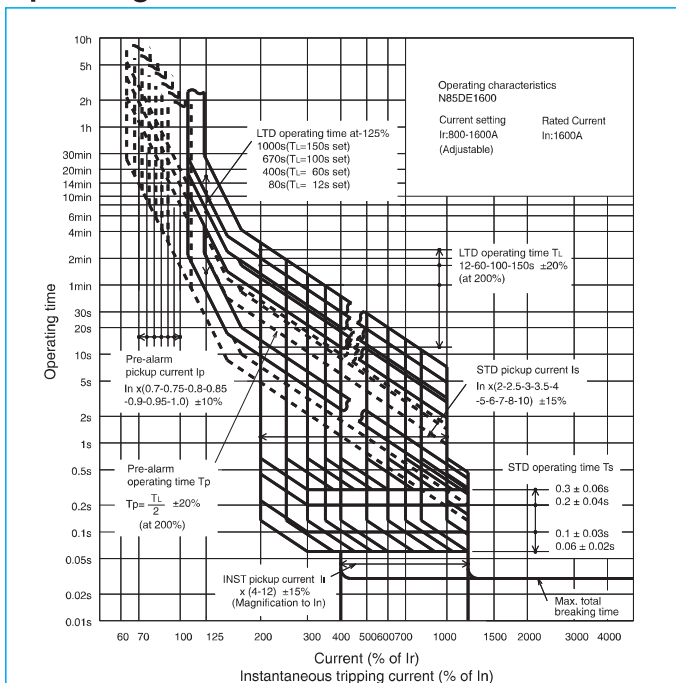

### Internal Accessories

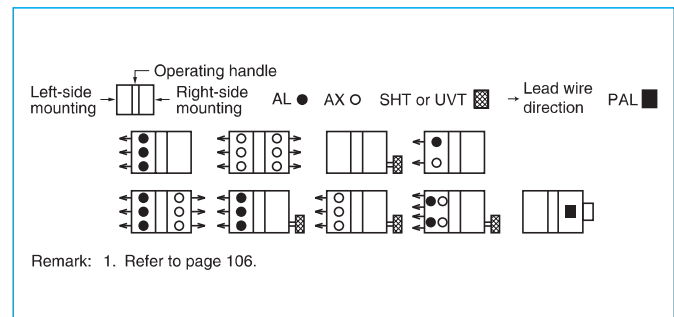

### Current Reducing Curve

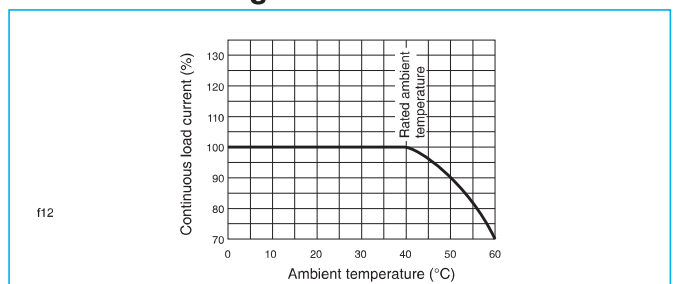

# N85DE1600

## Dimensional Drawings

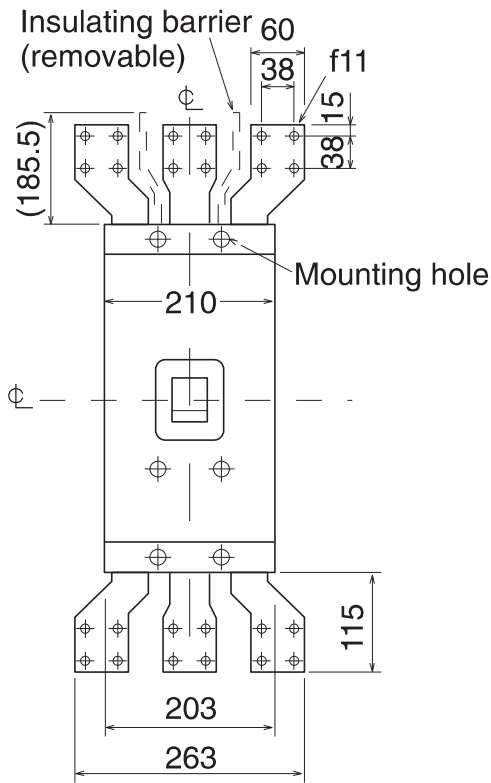

**3-pole**

Conductor thickness  $t=6W75$  max.

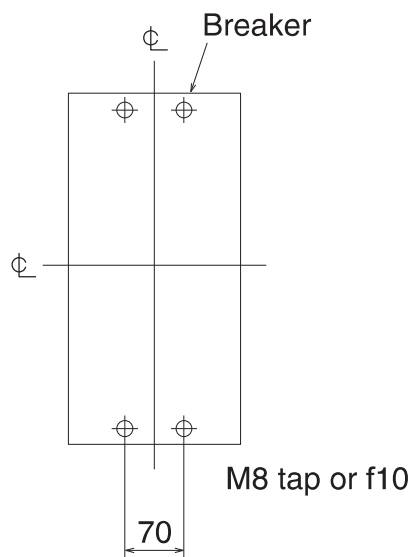
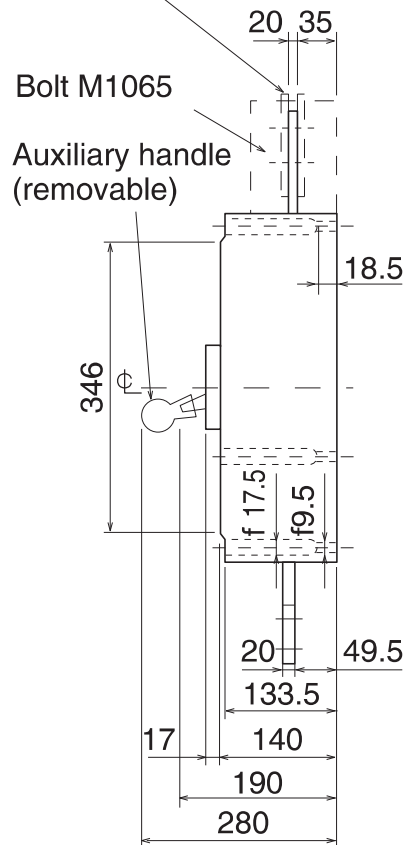

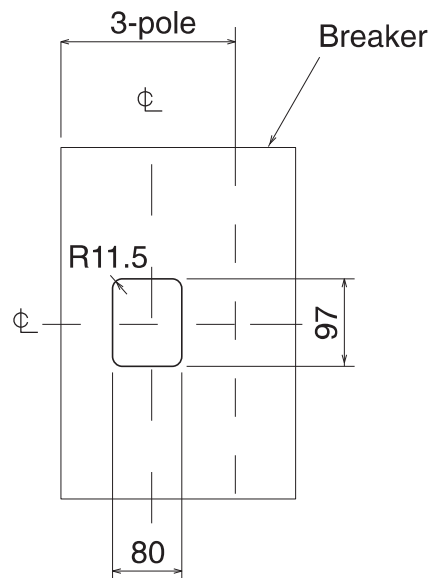

**3-pole**  
**Drilling plan**



1.0mm clearance on each side of the handle frame.

**Front-panel cutout**

## Torque Settings

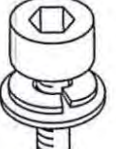
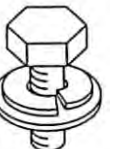
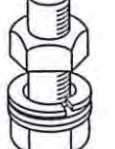
Terminal Screw	Screw diameter	M5	M6	M8			M12
	Shape						
	Fastening torque N-m	2-3	2.5-4.0	5.0-7.0	8.0-13.0	8.0-13.0	40.0-50.0

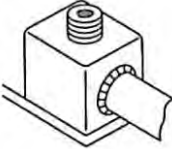
Solderless Terminal Screw	Screw diameter	M5	M10	M16	M18	M20	M24
	Shape						
	Fastening torque N-m	4.0-6.0	3.5-4.5	20.0-30.0	30.0-40.0	30.0-40.0	50.0-60.0

### Adjusting the rated current and tripping characteristics

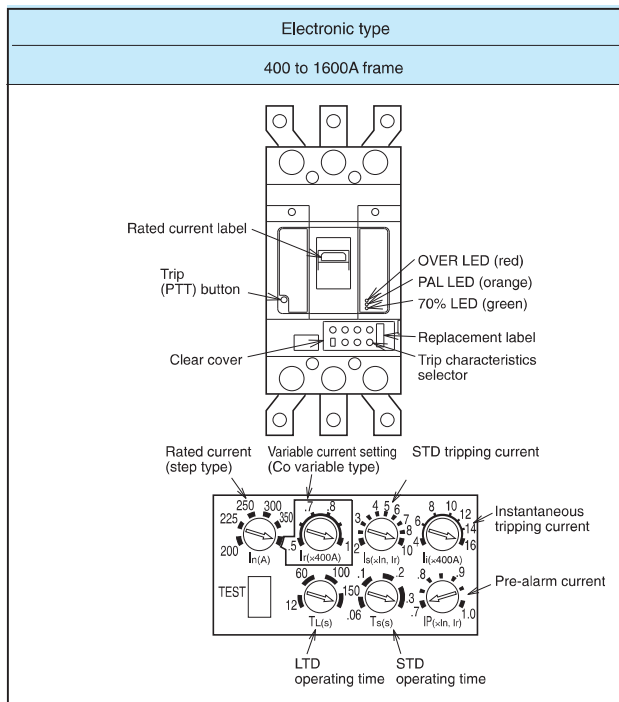

#### Note: Electronic units

Leave the CBI factory setting at maximum. Set for the specific condition in order to meet the product reliability expectations.

Set current using:

#### In fixed steps

50 - 100% of rating

Unit will default to the lowest if set in middle of two values.

IR 0.5 - 1.0 Variable action.

IP: Set pre alarm 0.7- 1.0 (70%-100%)

LED gives indication of MCCB loading

Green: All ok ●

Orange: Potential to trip if load is not reduced ●

Red: Tripping imminent! ●

For motor loads AC3 time settings

50%-100%

(Greater than 50% has motor load profile)

For standard loads (AC1) use 50% and lower.

Aim: Operate MCCB at lowest possible setting without tripping under normal use

Turn the handle to OFF before starting the settings.

① Open the clear cover.

② Set the arrow of each characteristic's setting dial to the required scale position. For values other than instantaneous tripping current and adjustable current settings, which can be adjusted at any time, always set the dial arrow within the bold lines of the setting value. If stopped at the middle, the adjacent setting value may be applied. Use a 0.6mm thick flat-tip screwdriver with a 4.5mm or less tip width. Turn the screwdriver at 0.05 Nm or less.

③ From the replacement labels, select the rated current label with the same value as the setting value.

## Cascading Table

CASCADING TABLE (CBI MCCBs and MCBs)												
UPSTREAM CIRCUIT BREAKERS												
No. OF POLES	G15D / F15D	G25D / F25D	G35D / F35D	F65DV	K25D	K35D	K65D	L65D	BUSBAR RATING kA RMS			
	3	3	3	3	3	3	3	3	3	65	65	3
FAULT LEVEL kA	15	25	35	65	25	35	65	65	65	250	400	65
AMP RATING	125	125	125	100	400	400	400	400	400	250	400	630
65				QH	QH	QH	QH	QH	QH	QH	QH	G15D / F15D
50				QH	QH	QH	QH	QH	QH	QH	QH	G15D / F15D
35			QH	QH	QH	QH	QH	QH	QH	QH	QH	G15D / F15D
30			QH	QH	QH	QH	QH	QH	QH	QH	QH	G15D / F15D
25		QF1	QF1	QF1	QF1	QF1	QF1	QF1	QF1	QF1	QF1	G15D / F15D
20		QF1	QF1	QF1	QF1	QF1	QF1	QF1	QF1	QF1	QF1	G15D / F15D
15	QF	QF1	QF1	QF1	QF1	QF1	QF1	QF1	QF1	QF1	QF1	G15D / F15D
10	QF	QF	QF	QF	QF	QF	QF	QF	QF	QF	QF	G15D / F15D
<b>PROSPECTIVE DOWNSTREAM FAULT LEVEL kA (RMS)</b>												
15												
10												

TYPE	MOUNTING TYPE	ESCUTCHEON, mm
QF/QH	Mini / DIN	57
	DIN	45

For more product information regarding cascading please contact CBI

F15D CAN CASCADE WITH ANY FD UPSTREAM BREAKER UP TO THE MAXIMUM FAULT LEVEL kA OF THE UPSTREAM BREAKER

**NOTES:**  
 QF = QF-(13), QF-(18), QF-(26)  
 QF\* = QF-(18), QF-(26) ONLY  
 QF1, QF1\* = Single pole circuit breakers  
 QF, QF\*, QH = Single, double or triple pole circuit breakers